



OFFICIAL NOTICE & AGENDA
REGULAR MEETING

MEETING: Wausau Water Works Commission
DATE/TIME: Tuesday, February 3, 2026 at 11:00 AM
LOCATION: Wausau City Hall – Council Chambers
407 Grant Street, Wausau WI, 54403

MEMBERS:
Mayor Doug Diny (P) Aaron Griner
Jim Force Deb Hadley
Peter Gelhar

1 Consideration of the minutes of the preceding meeting(s).

December 2, 2025 Regular Wausau Water Works Commission Minutes

2 Director's Reports.

- a. Drinking Water Division Updates- Leak Detection Results for 2025, 2025 Main Breaks and Repairs, 2025 Meter Exchanges, 2025 Locates completed, No water calls, 2026 Main Breaks/ Service Leak
- b. Drinking Water Division- Federal Lead and Copper Rule Revisions (LCRR) Update
- c. Wastewater Updates: Headworks Screening Project and Cherry Street Lift Station.
- d. Wastewater WPDES Permit Update

3 Discussion.

- a. Discussion on Water Rate Comparisons
- b. Update on the solar array project and possible schedule
- c. Discussion on the annual Payment in Lieu of Tax (PILOT) paid to the city by Wausau Water Works

4 Adjournment.

**Next meeting scheduled for March 3, 2026 @ 11:00 AM.*

Mayor Doug Diny, President

NOTICE POSTED AT CITY HALL (407 GRANT STREET) AND TRANSMITTED TO THE OFFICIALLY DESIGNATED NEWSPAPER

DATE: 01/28/2026

TIME: 2:45 PM

POSTED BY: Wausau Water Works



This meeting can be viewed on YouTube and Channel 981 on Cable TV

In accordance with the requirements of Title II of the Americans with Disabilities Act of 1990 (ADA), the City of Wausau will not discriminate against qualified individuals with disabilities on the basis of disability in its services, programs or activities. If you need assistance or reasonable accommodations in participating in this meeting or event due to a disability as defined under the ADA, please call the ADA Coordinator at (715) 261-6622 or ADAServices@ci.wausau.wi.us to discuss your accessibility needs. We ask your request be provided a minimum of 72 hours before the scheduled event or meeting. If a request is made less than 72 hours before the event the City of Wausau will make a good faith effort to accommodate your request.



City of Wausau
(715) 261-6500 | clerk@wausauwi.gov
wausauwi.gov





OFFICIAL MINUTES
REGULAR MEETING

MEETING: Wausau Water Works Commission
DATE/TIME: Tuesday, December 2, 2025 at 11:00 AM
LOCATION: Wausau City Hall – Council Chambers
407 Grant Street, Wausau WI, 54403

MEMBERS:
Mayor Doug Diny (P) Sarah Watson
Jim Force Deb Hadley
Peter Gelhar

Members Present: Doug Diny, Jim Force, Deb Hadley, Peter Gelhar
Members Not Present:
Members Excused:
Present 4, Not Present 0, Excused 0

Noting the presence of a quorum, the Chairperson called the meeting to order at 11:01 AM.

1 Consideration of the minutes of the preceding meeting(s).

October 7, 2025 Regular Wausau Water Works Commission Minutes

- Motion to Approve the minutes of October 7, 2025 with edits as discussed by Gelhar, Seconded by Hadley. Motion Passed 4-0.

2 Director's Report on Utility Operations.

Report placed on file.

a. Update on LSL 2025 Construction & 2026 Funding

Lindman summarized the memo from the packet with an update on the Lead Service Line Replacements and 2026 Funding.

Force commented his lead line was replaced and the contractor was professional; work was done well with minimal disturbance.

b. Update on the Solar Array Project and Next Steps

Lindman stated the project is estimated at \$2.8 million, with City Council approving borrowing up to that amount, reduced by any grants or tax credits. A Sole Source request will go to the Finance Committee on 12/9/2025 to hire for engineering services due to tight tax credit deadlines. The proposed solar site is east of the Treatment Plant, with final design details pending. Hadley opposed the sole source approach and questioned the project's ROI citing she is not in favor of the Solar Array Project. Lindman emphasized the need for sole source due to timeliness of the project to begin the construction process before July 2026 to qualify for the tax credit. Force reviewed the project's background, noting prior research, community input, and support for alternative energy despite some neighborhood opposition. The Solar Array Task Force was agreed upon by this Commission. We've done the homework, the payback is not fast, but I have no doubt it'll be successful. I'm happy we are moving ahead with an alternative energy project and will continue to support it.

c. Wastewater- Update on PFAS Test Results for Effluent and Biosolids

Brooks summarized occasional testing was requested by Commissioner Robinson to try and see where the PFAS results would be for the Effluent and Biosolids. Each test result gets submitted to the DNR, they could potentially use those numbers so we'd want to keep these testing more on a reserved side- results in the packet. Moving forward with the new issuance of the WPDES Permit,

we'll be testing the Effluent monthly and Biosolids every 2 months.

d. Wastewater- Headworks Screening Project Update

Brooks summarized a completion date set for October 2026, waiting for more equipment to be delivered, then work would continue to progress.

e. Wastewater- Cherry Street Lift Station Project Update

Brooks summarized the project was at a standstill. There's a bit of underground force main left to construct, the rest of the work would be above ground, then demo of the old lift station and site restoration to follow.

3 Discussion and Possible Action.

a. Approving the Lead Service Line Replacement (LSLR) Reimbursement Resolution for the 2026 Safe Drinking Water Loan and Principal Forgiveness.

Lindman summarized the draft resolution included a total of \$18,979,908. DNR's estimated grant of \$11,332,910 and \$7,646,998 in estimated loan. The resolution ensures the city/utility would be reimbursed for expenses prior to formal loan documents being prepared by the DNR, there'll be a revenue bond like 2025 and principal forgiveness. It's brought here, goes to Finance, then to Council as a joint resolution. Diny clarified DNR's loan interest of 0.25%.

- Motion to Approve the LSLR Reimbursement Resolution for the 2026 Safe Drinking Water Loan and Principal Forgiveness by Hadley, Seconded by Gelhar. Motion Passed 4-0.

4 Discussion and/or Updates.

a. On Construction Updates and Safe Drinking Water Loan Status Update for the Granular Activated Carbon and PFAS Treatment Project.

Wojtkiewicz reported the GAC has been operational for a little over a year. Changes were made to the chemical feed system. Polymer was added as pre-treatment to improve performance. There were 24 leaking air release valves replaced by the contractor at no cost to the city; a few remain. Overall, the project remains under budget. A change order is pending for coating the concrete floor in structure 120 to support long-term maintenance. With GAC, if you don't get a safe bacteriological (Bac-T) testing result, you can't use chlorine to disinfect because it damages the carbon. You'll need to utilize a caustic rinse. We did that with one of the vessels and it damaged the floor. DNR is allowing the floor coating with the loan. The variable frequency drives (VFD) networking are being adjusted to better integrate with the backup generators. Carbon replacement is approaching due to the PFAS breakthrough we're seeing. DNR has approved the use of reactivated carbon through a certified facility that regenerates the used carbon. That will be about 20% cost savings plus transportation costs. We don't have any regeneration facilities nearby; they're in Oklahoma and Pennsylvania. The vendor would replace 1 or 2 vessels with virgin carbon, then we'll replace the remaining vessels with regenerated carbon over time. There are 12 vessels total in a lead/lag configuration, 6 systems of 2 vessels each. The process would be to remove the lead system vessels, then the lag system vessels become the lead. Hadley questioned the cost and amount of changeout required. Wojtkiewicz estimated the cost of carbon changeout is about \$800k to \$1 million. Going into this, we weren't sure DNR would allow reactivated carbon, but now they've said it's allowed. Lindman replied every year, but if we're doing 1 or 2 vessels at a time, it'll be several months to replace all of them. Diny stated we can plan the timing and budget, but it depends on the water flow and usage too.

b. On the Proposed WPDES Draft Permit for the Wastewater Treatment Facility.

Brooks summarized the draft WPDES permit was received November 3rd, DNR allows us 1 week to respond and provide comment with factual inaccuracies. We have Municipal Environmental Group (MEG) review it along with Lindman, Fable and myself, there are some preliminary comments. The reasoning for factual review is to find any discrepancies, errors or contested items before the next process, which is public notice and comment that ends December 22nd. DNR reviews and makes final adjustments by January 2026. The WPDES will require us to collect 2 years of biosolids to form their calculations and limits. Force questioned if there would be any significant changes between the new/old permit. Brooks replied the PFAS testing on the Effluent and Biosolids. They went from the fecal coliform testing on the effluent for the bacteria counts to e-coli, which is a better indicator of the pathogens in the wastewater for recreational users in the Wisconsin river. We did preliminary testing that showed we're below the limits they want to impose. No change in phosphorus. Lindman summarized the permit and requirements are good as can be but there's still some unknowns with PFAS which can be concerning. We'll see how that evolves overtime.

5 Adjournment.

Next meeting scheduled January 6, 2026 at 11:00 AM.

- Motion to adjourn by Hadley, Seconded by Gelhar. Motion carried 4-0

The recording of this meeting may be viewed on
YouTube [@CityofWausauMeetings](#)



City of Wausau
(715) 261-6500 | clerk@wausauwi.gov
wausauwi.gov





Wausau Water Works
Scott Boers, Water Operations Superintendent

DATE: February 3, 2026
TO: Wausau Water Works Commission
SUBJECT: Drinking Water Division Updates- Leak Detection Results for 2025, 2025 Main Breaks and Repairs, 2025 Meter Exchanges, 2025 Locates completed, No water calls, 2026 Main Breaks/ Service Leak

PURPOSE

Drinking Water Division – Director's Report Updates

BACKGROUND

1. Leak detection results for 2025.
 - a. Asterra did 2 scans in 2025, one in March and the other in August. The March scan determined 76 points of interest (poi), of which we found 1 main break, 2 service leaks, and 3 hydrant leaks. The August scan noted 59 poi's, and we found no leaks.
 - b. Westrum Leak Detection performed a city-wide survey the last week of August. He found 4 suspected main breaks, 6 service leaks and 6 leaking hydrants. (leak report attached)
2. In 2025, Staff repaired 26 main breaks and replaced or repaired 32 services.
3. Staff replaced 2744 meters in 2025. The oldest meters replaced were from 1973. Of the 5/3 size household meters changed, about 35% failed to meet WPSC accuracy standards.
4. In 2025, staff completed 7,603 locates.
5. As of 1/27/26, even with the cold snap we haven't yet had any laterals freeze. Staff have, however, been very busy with no water calls due to conditions of customer residences.
6. With the cold came water leaks, staff repaired 5 main breaks and a service leak from 1/21 to 1/26.

RECOMMENDATION

Wausau, Wi.

Computerized Leak Detection Survey

9/2/25

Cost Analysis

This survey was conducted by Westrum Leak Detection utilizing the latest leak detection correlation technology to pinpoint suspected leakage in the system. The following leaks were located.

Leak Chart is \$1 per 1000 gallons lost

	No. of Leaks	GPD (per leak)	Millions per year	Dollars per year
Main leaks	4	10,000	14.6	\$14,600
Abandoned leaks	0	0	0	\$0
Service line leaks	6	6,000	13.14	\$13,140
Valve leaks	0	0	0	\$0
Hydrant leaks	6	500	1.095	\$1,095
Total	16	16,500	28.835	\$28,835

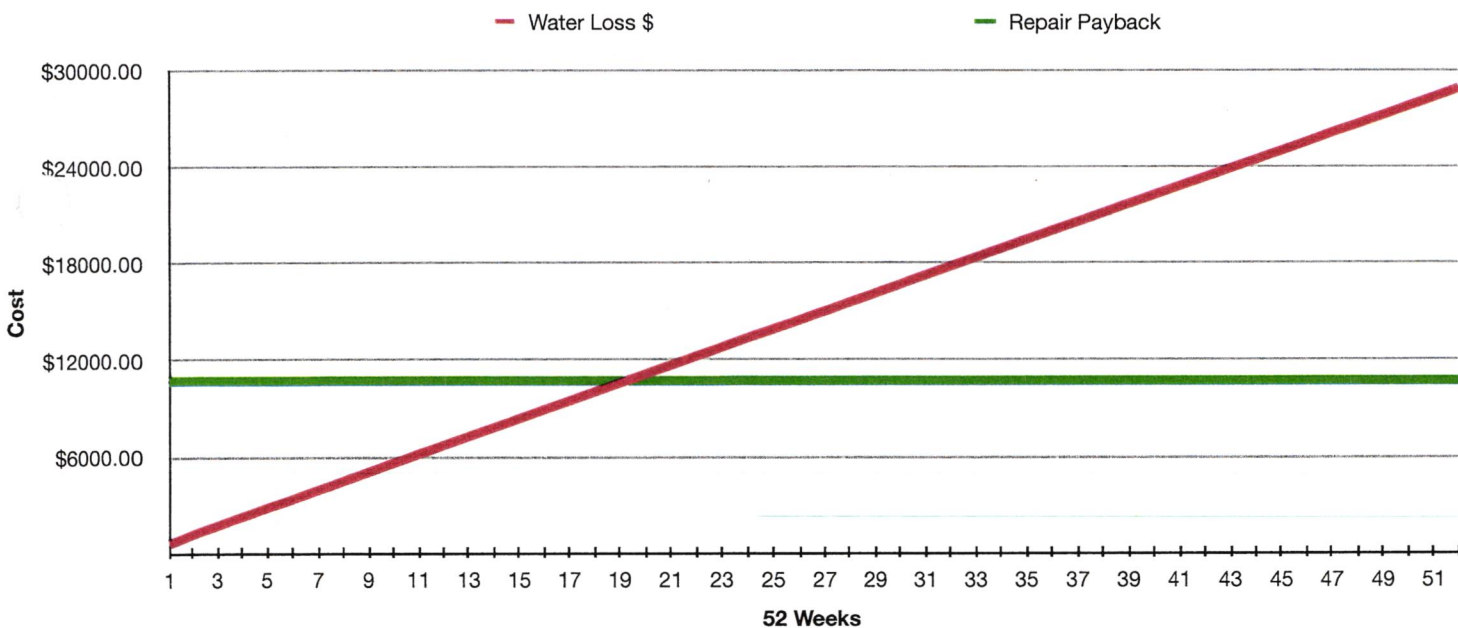

Survey Cost	\$10,700.00
Leak cost per week:	\$555
Estimated payback period in weeks:	19

As you know, because of increased production and test and maintenance costs, operation and maintaining an efficient water distribution system has become a necessity. The most effective method to reach and maintain that goal is with an annual leak detection program. We appreciate the opportunity to serve you.

WESTRUM LEAK DETECTION	3226 360th St Stratford, IA 50249	515-838-2222 (24-7) 888-500-4433 (24-7)	Cell 515-231-0122
---------------------------	--------------------------------------	--	-------------------

- Manhole 
- Stop Box 
- Hydrant 
- Valve 

<h1 style="margin: 0;">Wausau, Wi.</h1>		
Survey <input checked="" type="checkbox"/>	Service <input type="checkbox"/>	Date - 9/2/25

Leak #
1



Leak Indication

This service line is leaking between the curb box and the main.

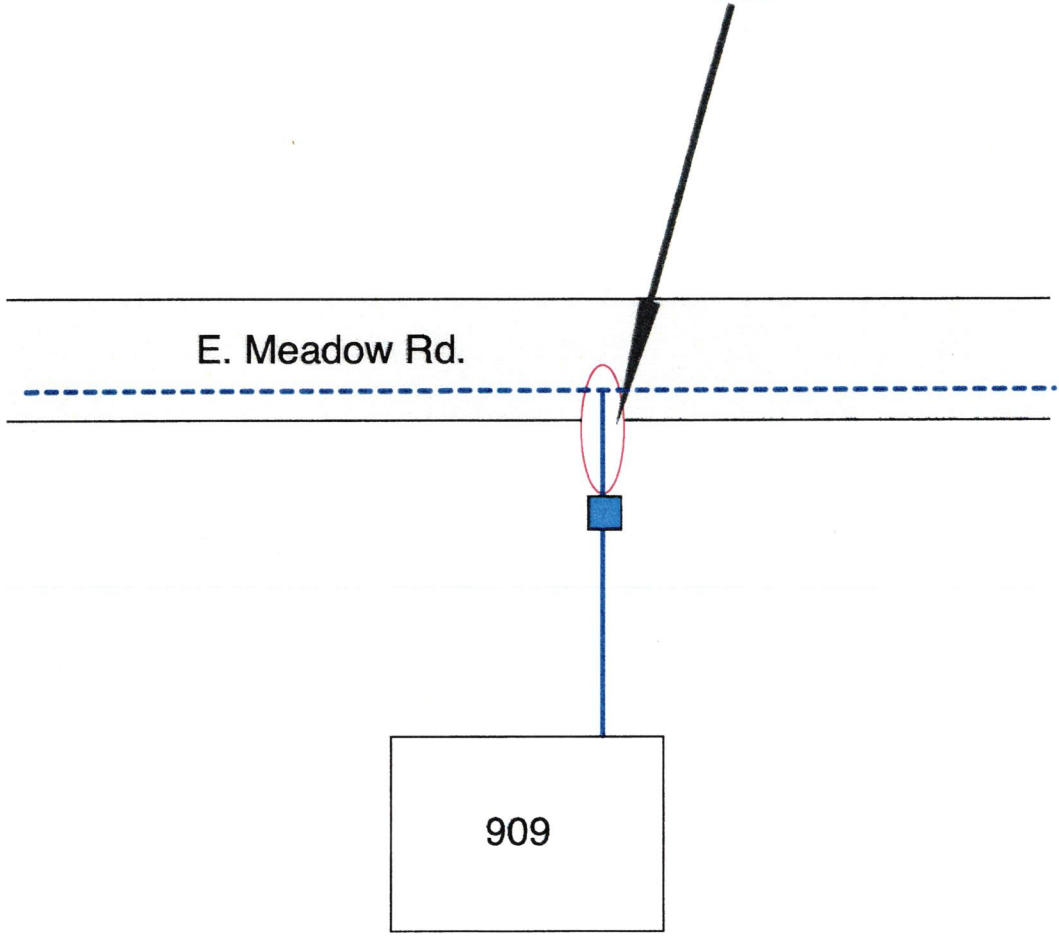

Westrum Leak Detection
 3226 360th St
 Stratford, IA 50249
 1-888-500-4433 - 24/7

Date Repaired
9/11/25

Operate stop box
 YES NO

Description of Repair
Renewed service (City side)

- Manhole ●
- Stop Box ■
- Hydrant ⦿
- Valve ⊠

Wausau, Wi.

Leak #
2

Survey Service Date - 9/2/25



Leak Indication

This service line is leaking between the curb box and the house.

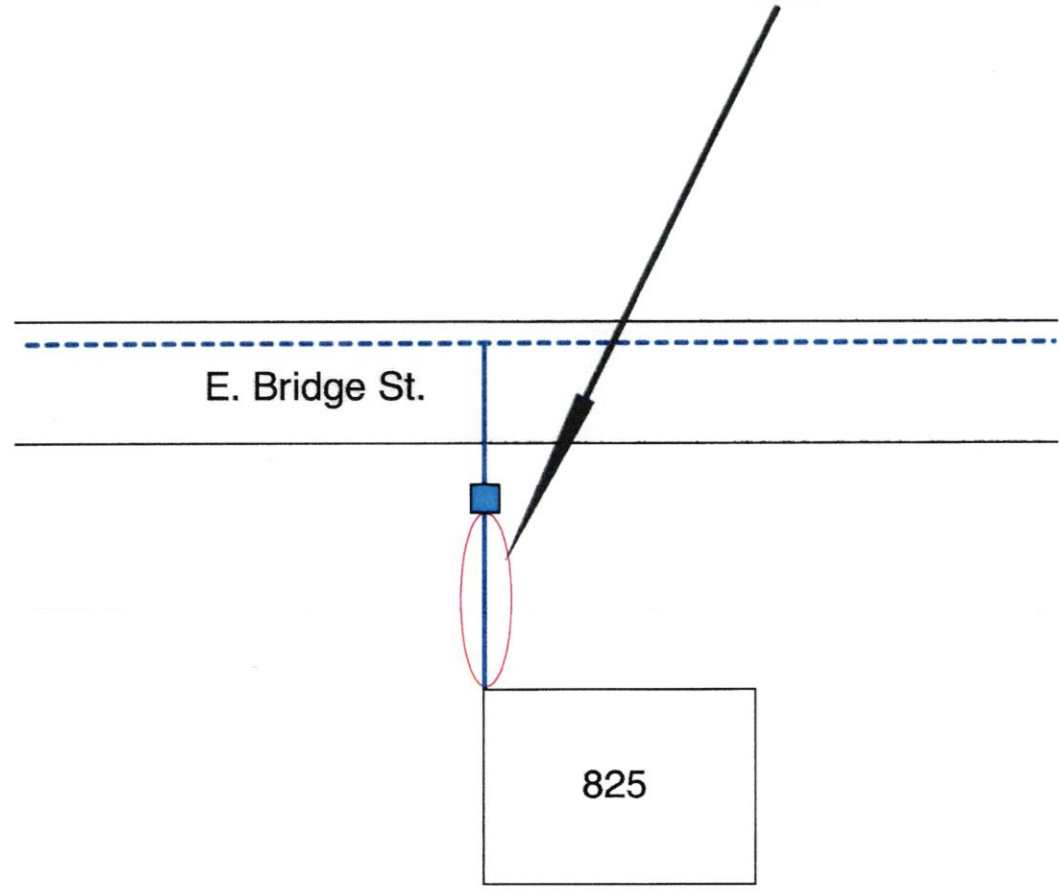

Westrum Leak Detection
 3226 360th St
 Stratford, IA 50249
 1-888-500-4433 - 24/7

Date Repaired
9/12/25

Operate stop box
 YES NO

Description of Repair
 Reversed service Leak at stop HO side & ours (Lead on HO side)

- Manhole ●
- Stop Box ■
- Hydrant ●
- Valve ⊠

<h1 style="margin: 0;">Wausau, Wi.</h1>		
Survey <input checked="" type="checkbox"/>	Service <input type="checkbox"/>	Date - 9/2/25

Leak #
3



Leak Indication

Main leak 26' from valve A. Leak area is marked in the street.

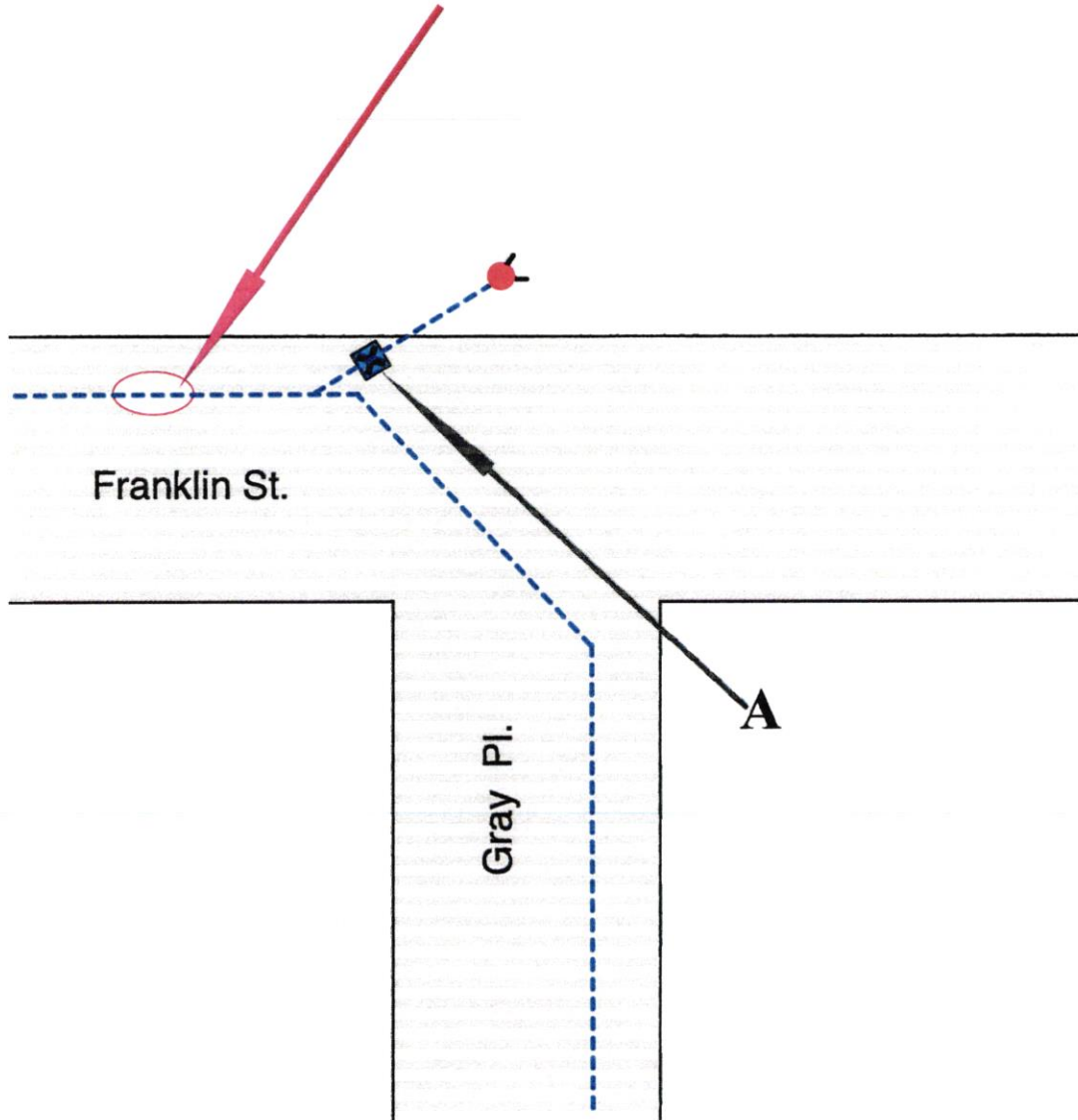

Westrum Leak Detection

3226 360th St
Stratford, IA 50249
1-888-500-4433 - 24/7

Date Repaired

9/15/25

Operate stop box

YES NO

Description of Repair

Pipe rotted just behind Break
in April Mega Lug Pushed through
Pipe

- Manhole ●
- Stop Box ■
- Hydrant ⦿
- Valve ⊠

<h1 style="margin: 0;">Wausau, Wi.</h1>		
Survey <input checked="" type="checkbox"/>	Service <input type="checkbox"/>	Date - 9/2/25

Leak #
4



Leak Indication

This service line is leaking between the curb box and the main. This could be a main leak to the west of the corporation tap to #738.

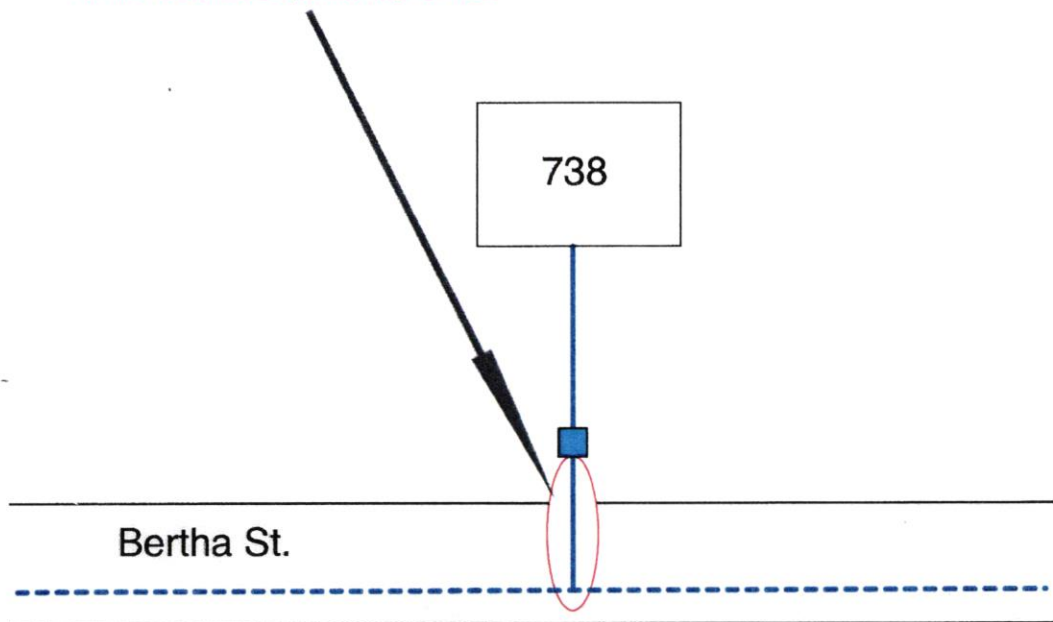

Westrum Leak Detection

3226 360th St
Stratford, IA 50249
1-888-500-4433 - 24/7

Date Repaired

Operate stop box

YES NO

Description of Repair

LSL Contractor neglected to turn off old Corp

- Manhole
- Stop Box
- Hydrant
- Valve

<h1 style="margin: 0;">Wausau, Wi.</h1>		
Survey <input checked="" type="checkbox"/>	Service <input type="checkbox"/>	Date - 9/2/25

Leak #
5



Leak Indication

This service line is leaking
between the curb box and the
house.

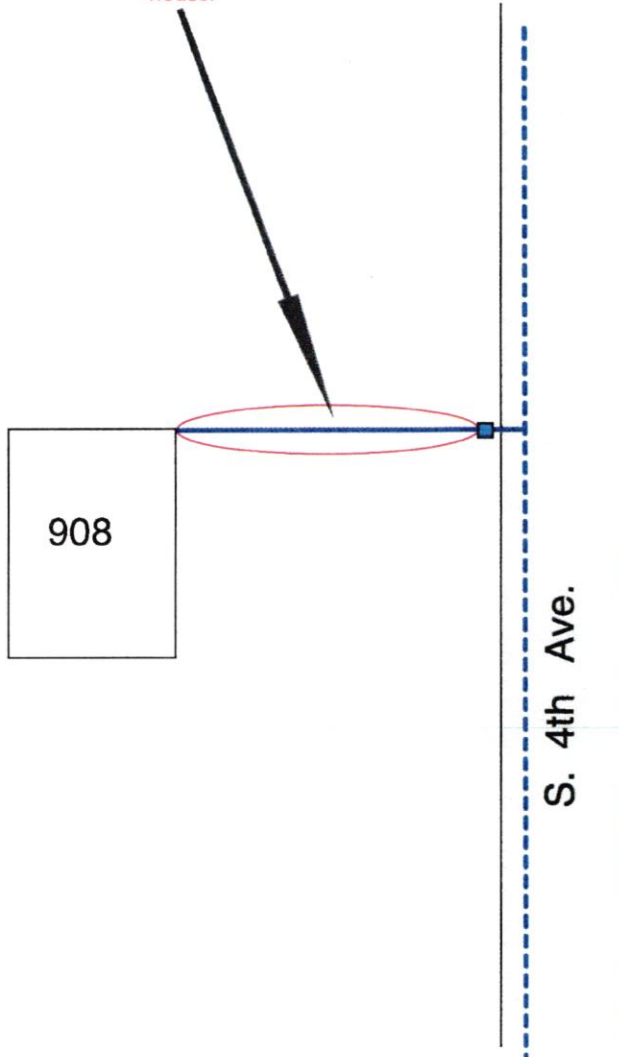

Westrum Leak Detection

3226 360th St
Stratford, IA 50249
1-888-500-4433 - 24/7

Date Repaired

9/9/25

Operate stop box

YES NO

Description of Repair

5-star Replad Service
on both sides

- Manhole
- Stop Box
- Hydrant
- Valve

<h1 style="margin: 0;">Wausau, Wi.</h1>		
Survey <input checked="" type="checkbox"/>	Service <input type="checkbox"/>	Date - 9/2/25

Leak #
6



Leak Indication

This service line is leaking
between the curb box and the
main.

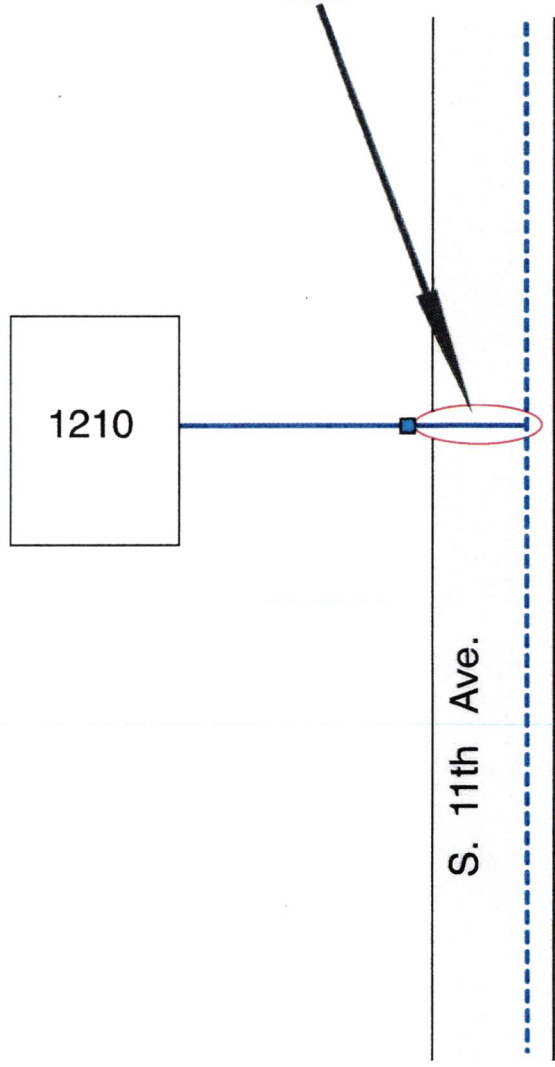

Westrum Leak Detection
 3226 360th St
 Stratford, IA 50249
 1-888-500-4433 - 24/7

Date Repaired

Operate stop box

YES NO

Description of Repair

- Manhole 
- Stop Box 
- Hydrant 
- Valve 

<h1 style="margin: 0;">Wausau, Wi.</h1>		
Survey <input checked="" type="checkbox"/>	Service <input type="checkbox"/>	Date - 9/2/25

Leak #
7



Leak Indication

This hydrant was leaking badly.
We flushed hydrant and it stopped leaking.

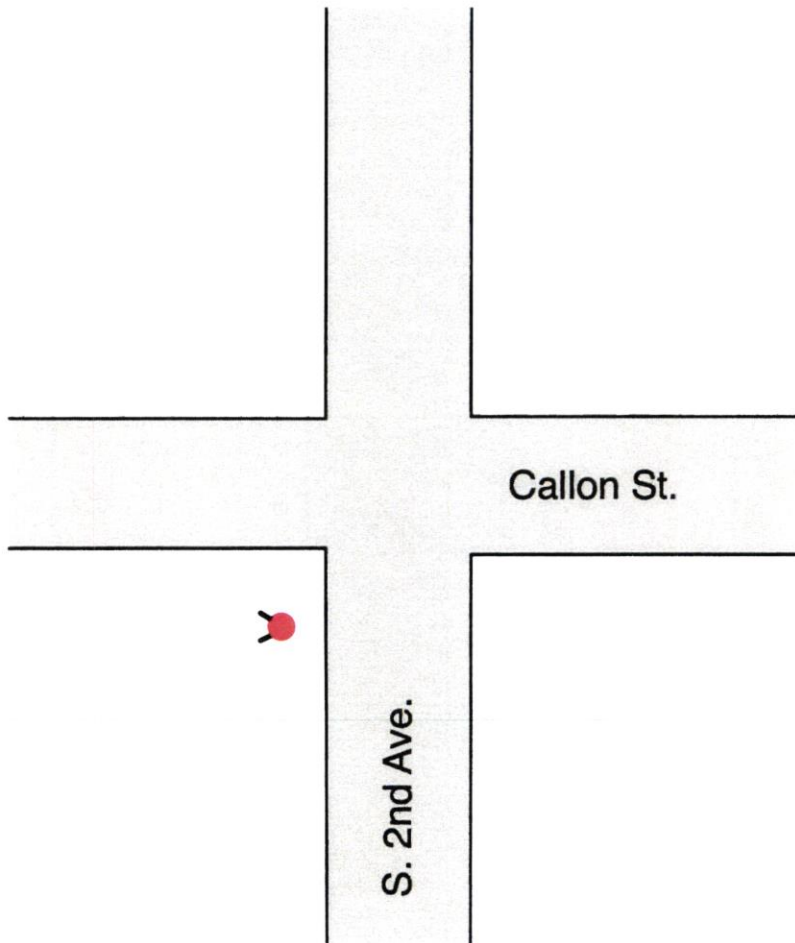

Westrum Leak Detection
3226 360th St
Stratford, IA 50249
1-888-500-4433 - 24/7

Date Repaired
9/2/25

Operate stop box

YES NO

Description of Repair

Flushed out chunk in
Leather.
Good to go now

- Manhole 
- Stop Box 
- Hydrant 
- Valve 

<h1 style="margin: 0;">Wausau, Wi.</h1>		
Survey <input checked="" type="checkbox"/>	Service <input type="checkbox"/>	Date - 9/2/25

Leak #
8



Leak Indication

This service line is leaking
between the curb box and the
main.

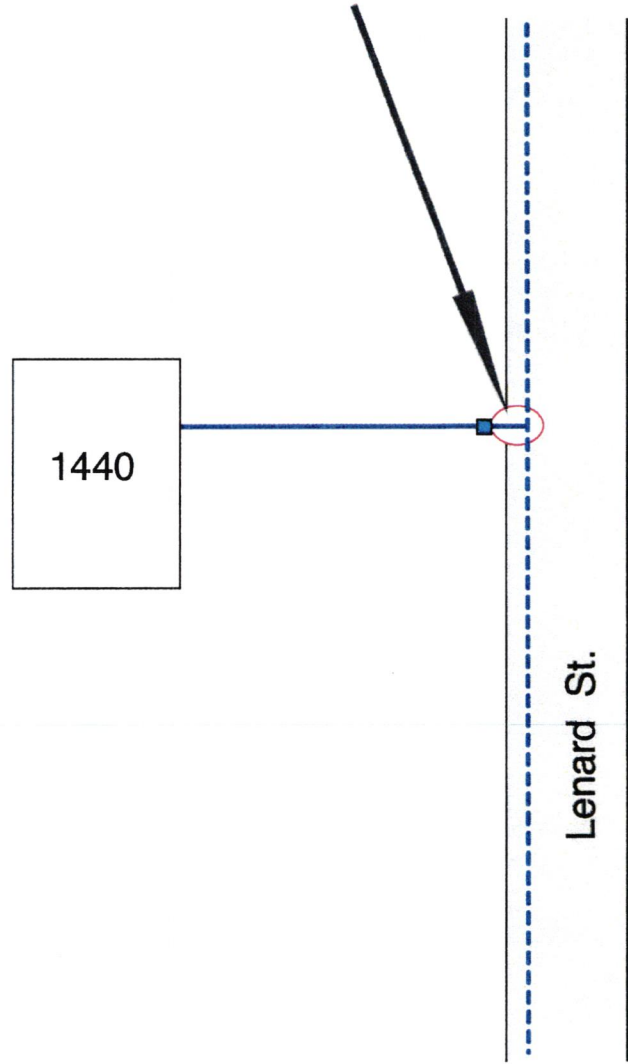

Westrum Leak Detection
3226 360th St
Stratford, IA 50249
1-888-500-4433 - 24/7

Date Repaired

Operate stop box
 YES NO

Description of Repair

- Manhole 
- Stop Box 
- Hydrant 
- Valve 

<h1 style="margin: 0;">Wausau, Wi.</h1>		
Survey <input checked="" type="checkbox"/>	Service <input type="checkbox"/>	Date - 9/2/25

Leak #
9

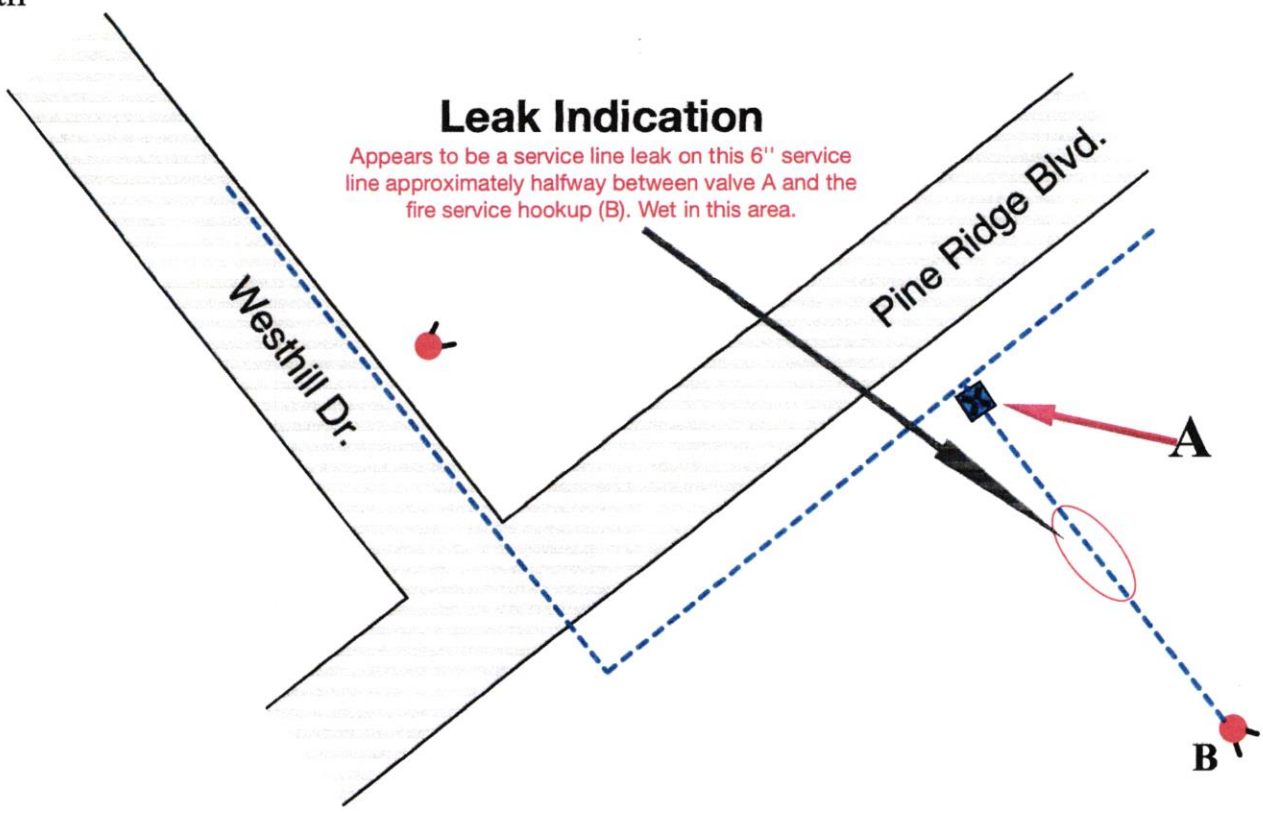

Westrum Leak Detection
 3226 360th St
 Stratford, IA 50249
 1-888-500-4433 - 24/7

Date Repaired

Operate stop box

YES NO

Description of Repair

- Manhole ●
- Stop Box ■
- Hydrant ⚓
- Valve ⊠

<h1 style="margin: 0;">Wausau, Wi.</h1>		
Survey <input checked="" type="checkbox"/>	Service <input type="checkbox"/>	Date - 9/2/25

Leak #
10



Leak Indication

Appears to be a main leak at or near valve **A**.

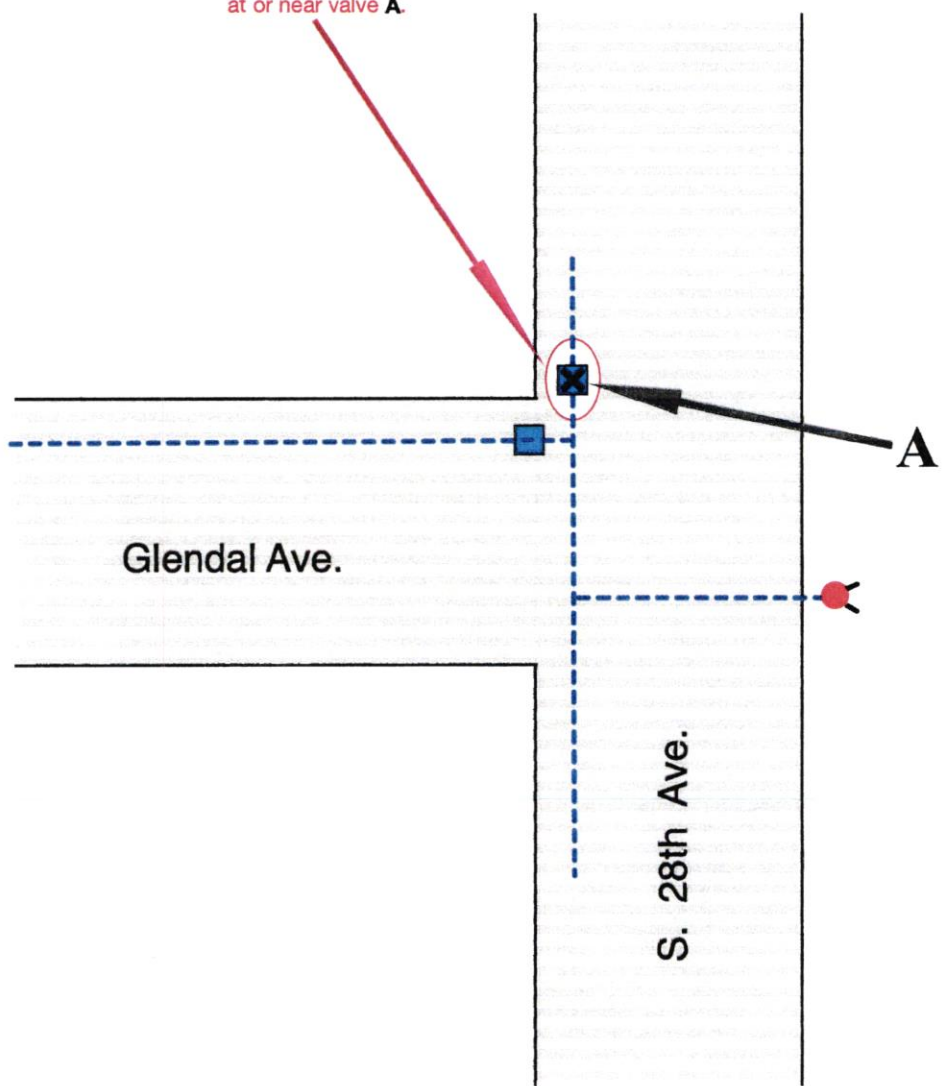

Westrum Leak Detection
 3226 360th St
 Stratford, IA 50249
 1-888-500-4433 - 24/7

Date Repaired
9/10/25
Operate stop box
 YES NO

Description of Repair

14" steel spical pipe
Rotten

- Manhole
- Stop Box
- Hydrant
- Valve

Wausau, Wi.

Survey Service Date - 9/2/25

Leak #
11

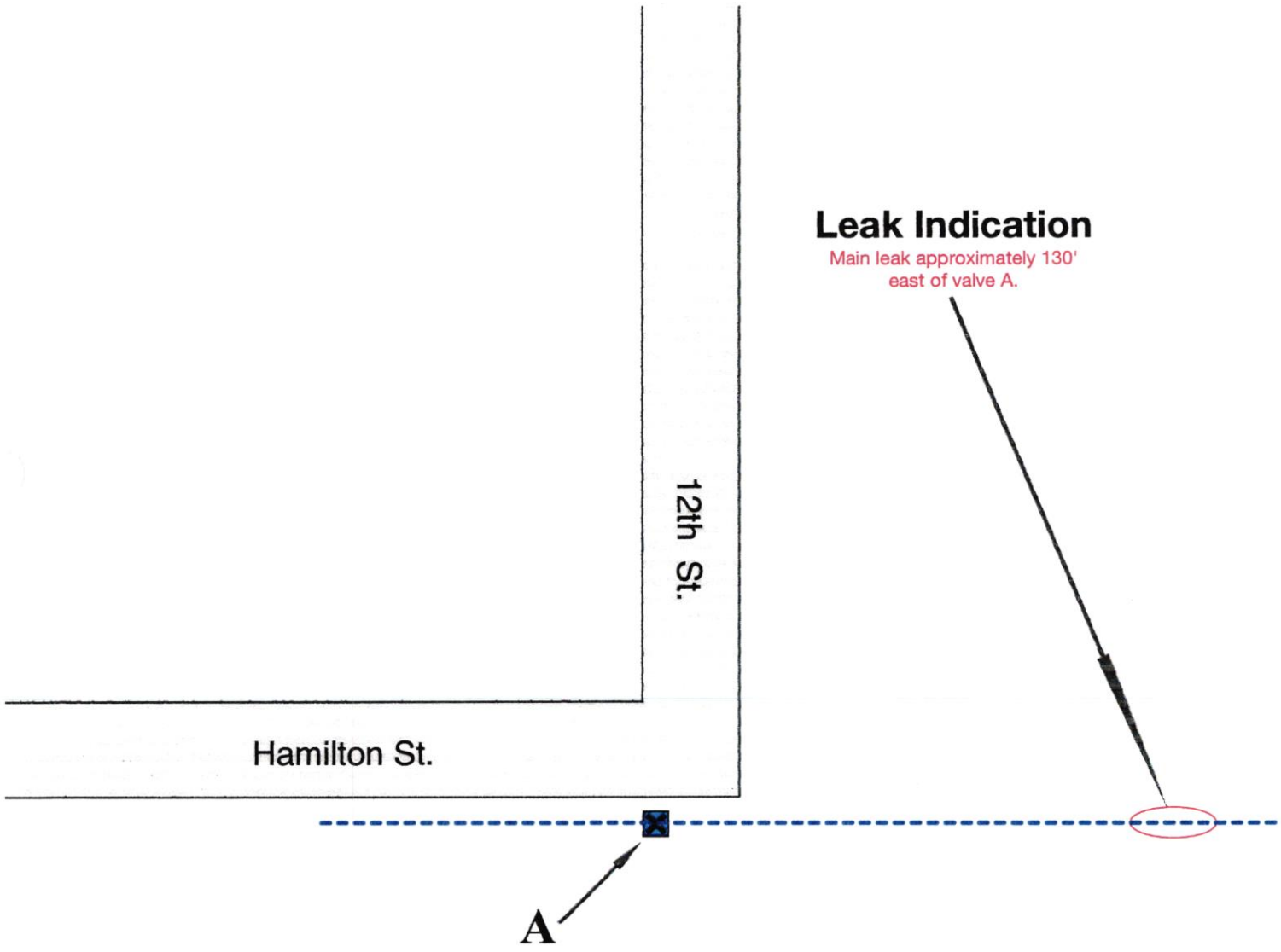

Westrum Leak Detection
 3226 360th St
 Stratford, IA 50249
 1-888-500-4433 - 24/7

Date Repaired

Operate stop box
 YES NO

Description of Repair

Service leak - repaired

- Manhole
- Stop Box
- Hydrant
- Valve

<h1 style="margin: 0;">Wausau, Wi.</h1>		
Survey <input checked="" type="checkbox"/>	Service <input type="checkbox"/>	Date - 9/2/25

Leak #
12



Leak Indication

This hydrant is leaking.

E. Thomas St.



129

Westrum Leak Detection

3226 360th St
Stratford, IA 50249
1-888-500-4433 - 24/7

Date Repaired

Operate stop box

YES NO

Description of Repair

- Manhole 
- Stop Box 
- Hydrant 
- Valve 

<h1 style="margin: 0;">Wausau, Wi.</h1>		
Survey <input checked="" type="checkbox"/>	Service <input type="checkbox"/>	Date - 9/2/25

Leak #
13



Leak Indication

This hydrant is leaking.

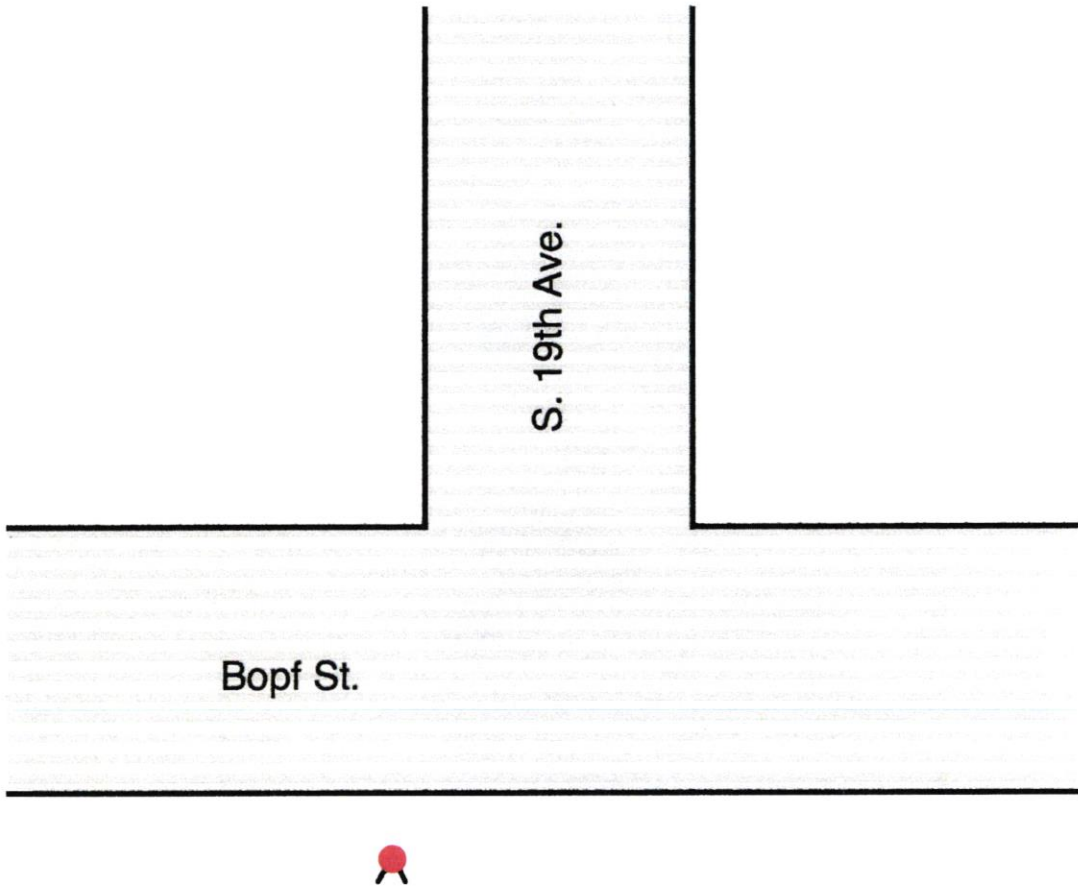

Westrum Leak Detection





3226 360th St
Stratford, IA 50249
1-888-500-4433 - 24/7

Date Repaired

Operate stop box

<input type="checkbox"/>	<input checked="" type="checkbox"/>
YES	NO

Description of Repair

- Manhole 
- Stop Box 
- Hydrant 
- Valve 

<h1 style="margin: 0;">Wausau, Wi.</h1>		
Survey <input checked="" type="checkbox"/>	Service <input type="checkbox"/>	Date - 9/2/25

Leak #
14



Leak Indication

This hydrant is leaking.

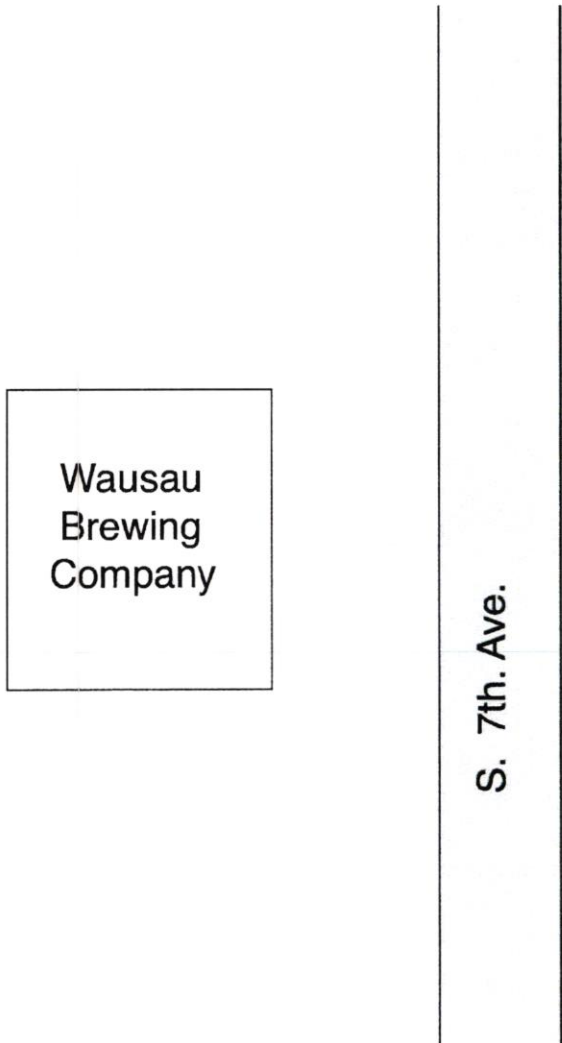

Westrum Leak Detection
 3226 360th St
 Stratford, IA 50249
 1-888-500-4433 - 24/7

Date Repaired

Operate stop box

YES NO

Description of Repair

- Manhole
- Stop Box
- Hydrant
- Valve

<h1 style="margin: 0;">Wausau, Wi.</h1>		
Survey <input checked="" type="checkbox"/>	Service <input type="checkbox"/>	Date - 9/2/25

Leak #
15



Leak Indication
This hydrant is leaking.

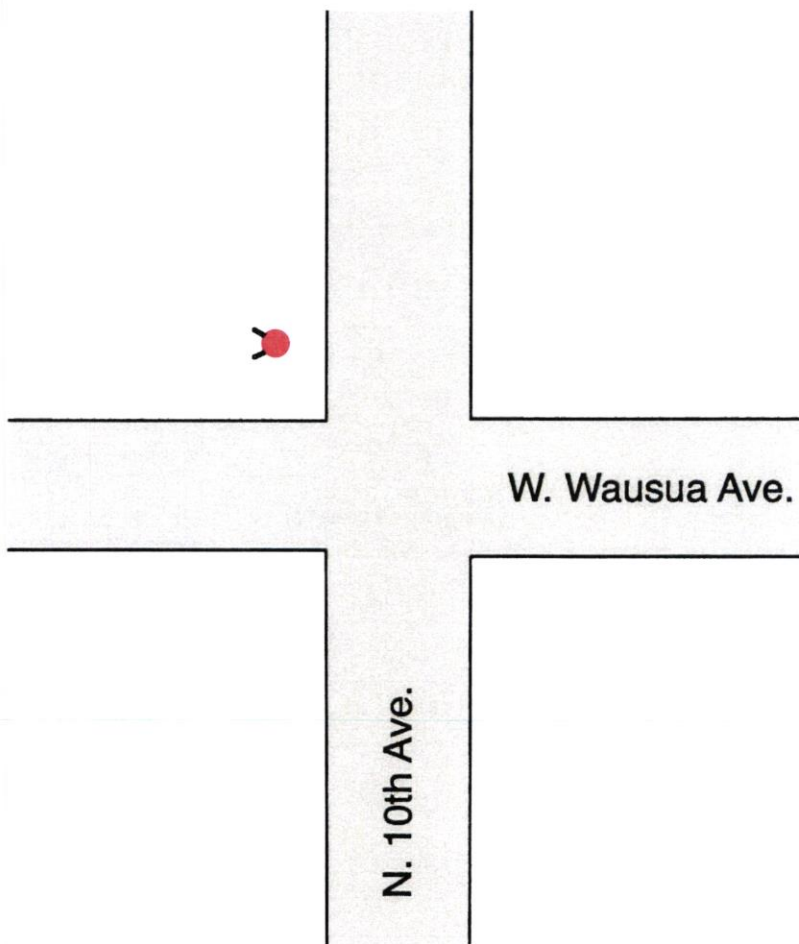

Westrum Leak Detection
3226 360th St
Stratford, IA 50249
1-888-500-4433 - 24/7

Date Repaired

Operate stop box

YES NO

Description of Repair

- Manhole 
- Stop Box 
- Hydrant 
- Valve 

<h1 style="margin: 0;">Wausau, Wi.</h1>		
Survey <input checked="" type="checkbox"/>	Service <input type="checkbox"/>	Date - 9/2/25

Leak #
16



Leak Indication

This hydrant is leaking.

3400



Polzer Dr.

Westrum Leak Detection

3226 360th St
 Stratford, IA 50249
 1-888-500-4433 - 24/7

Date Repaired

Operate stop box

YES NO

Description of Repair



Wausau Water Works
Scott Boers, Water Operations Superintendent

DATE: February 3, 2026
TO: Wausau Water Works Commission
SUBJECT: Drinking Water Division- Federal Lead and Copper Rule Revisions (LCRR) Update

PURPOSE

Federal Lead and Copper Rule Revisions (LCRR) Update

BACKGROUND

To meet the requirements of the Federal Lead and Copper Rule Revisions (LCRR), in December the water department mailed 7,957 notices to customers with Galvanized (62), Lead (3,518) and Unknown possibly lead (4,377) service laterals. This is an annually recurring requirement, until all services are identified not lead or replaced.

RECOMMENDATION



**Wausau Water Works
Ben Brooks, Wastewater Superintendent**

DATE: February 3, 2026
TO: Wausau Water Works Commission
SUBJECT: Wastewater Updates: Headworks Screening Project and Cherry Street Lift Station.

PURPOSE

Headworks Screening Project and Cherry Street Lift Station Updates

BACKGROUND

1. Headworks Screening Project Update:

- Ahern & subcontractors mobilized: 06/16/2025.
- Substantial Completion: 10/15/2026.
- Final Completion: 11/15/2026.
- Hydrodyne Screens were received on 12/11/2025. In preparation for the installation of the new screens, one of the old Huber step screens was decommissioned and removed. Upon removal, it was discovered that the concrete of the influent channel had become compromised over the years by hydrogen sulfide. The influent channel was of 1969 construction. Donohue and Ahern made the decision that a new coating was required prior to the installation of the new Hydrodyne step screen, which required a change order. The change order will include the repair work of both influent channels. Change Order not to exceed \$28,000.00

2. Cherry St. Lift Station project update:

- Integrity mobilized on site: 09/08/2025, Substantial Completion Date: 01/31/2026 (new lift station operating with demo work completed)
- Final Completion Date: 05/15/2026 (all work complete, with grass actively growing)
- Equipment and enclosure were delivered on 12/12/2025. The contractor is currently working on the installation of the control panel with an anticipated start up date of 02/03/2026.

RECOMMENDATION



Wausau Water Works
Ben Brooks, Wastewater Superintendent

DATE: February 3, 2026
TO: Wausau Water Works Commission
SUBJECT: Wastewater WPDES Permit Update

PURPOSE

WPDES Permit Update

BACKGROUND

WPDES Public Comment Period ended 12/22/2025 at 4:30PM.

-
- Wastewater Treatment Plant provided comment back to the WDNR on December 19, 2025 at 3:28 PM. Email response with comments attached.
 - If the WDNR finds that the comments noted in the email response are factual, they will edit the final WPDES permit to reflect the changes requested prior to issuance of the new discharge permit to the City.

RECOMMENDATION

Ben Brooks

From: Ben Brooks
Sent: Friday, December 19, 2025 3:28 PM
To: Angela.Parkhurst@wisconsin.gov
Cc: Lindstrom, Nicholas E - DNR
Subject: Wausau Waterworks - Wastewater: 30 day public comment response.

Angela, please consider this email as response to the 30 day public comment period regarding the Wausau Waterworks Wastewater draft WPDES Permit.

Comments and request below:

- 1.) 3.2.1 Sampling Point (Outfall) 001 – Effluent to Wisconsin River
 - E.coli sample frequency on draft listed a sample frequency of 2/Week. Expired permit required a sample frequency of 1/Wk for Fecals and during the E.coli monitoring period it was also 1/Wk.
 - I am requesting that the sampling frequency requirement of E.coli monitoring match that of the expired permit with a sampling frequency of 1/Wk.
- 2.) It is very unfortunate that Wausau Waterworks-Wastewater has still not received its final approval letter from the WDNR with Class A, EQ Biosolids designation. All required information has been submitted to the WDNR along with the final SMP for review and final approval. It has been two years if not longer. We have consistently produced Class A, EQ Sludge. Since the City hasn't received its final approval letter from the WDNR we have been testing Class B AND Class A sludge for the entire duration and it has become very costly. I will not discontinue testing Class B sludge until we receive a final approval letter from the WDNR.
 - Permit Modifications will be necessary at the time Class A, EQ Biosolids approval is received.
- 3.) PFAS/Biosolids sample point clarification needed on Draft Permit: All Sampling Points listed on 4.1 are not discharge points. The PFAS sampling frequency requirement should be indicated on the specific Sampling Point Number listed in 4.1
 - 4.2.1.8 Sludge Monitoring for PFAS: Monitoring shall occur at each sample point when sludge is generated and discharged regardless of the end use (ie. Land applied, hauled to another facility, landfilled). This language is very vague and doesn't define the exact sample point location's required for PFAS sample collection. Needs to be cleaned up to define specific locations of where samples need to be taken.

If I come up with any additional comments over the weekend, I will be sure to submit by 4:30pm on Monday, 12/22/25

Thank you,

BEN BROOKS

Superintendent
Wausau Waterworks -Wastewater
430 Adrian Street
Wausau, Wi. 54401
Office: 715-261-6941
Email: Ben.Brooks@wausauwi.gov



Memorandum

Date: 1/16/2026
To: Utility Commission
From: Scott Boers
Re: Water Rate Comparisons

Lately, I have received several inquiries regarding our rates as compared to other utilities. People believe Wausau has “the highest water rates in the state” which is not true.

The following spreadsheets are Water Bill Comparisons run from the Wisconsin Public Service Commission’s Website. For consistency in comparison the quarterly bill charge was figured at the meter charge plus 18,750 gallons of water used, or about 25 units.

The first sheet is a comparison of water rates for all the utilities in Marathon County. Using the above criteria, Wausau has the 8th highest rate in the county. The second sheet is a comparison of all AB Class utilities. AB Class are those utilities having 4000 or more customers. Of those utilities, Wausau has the 16th highest rates. The last spreadsheet shows all the water utilities in the state. Of the 575 compared, Wausau has the 187th highest rate.

Water rates will be a very dynamic subject for many utilities in the next couple years. There are several pending regulations which could increase costs for treatment and operations. I felt it would be important to show how our rates compare to our neighbors and in the State.

Sheet 1- Marathon County Water Utilities

Utility ID	Utility Name	Rate Schedule	County	Utility Class	Minimum Quarterly Bill (0.625 inch meter)	6000 GAL	12000 GAL	15000 GAL	18750 GAL	75000 GAL	Effective Date	Footnote	Total Meter and 18750 gal
3298	Maine Water Utility	Mg-1	Marathon	D	57.06	125.16	193.26	227.31	269.87	908.31	1/1/2022		326.93
1660	Village of Dorchester Water Utility	Mg-1	Marathon	D	54	99	144	166.5	194.63	578.25	9/26/2013		248.63
5620	Spencer Municipal Water Utility	Mg-1	Marathon	D	48	95.76	143.52	167.4	197.25	615.84	9/1/2023		245.25
10	Abbotsford Municipal Water Utility	Mg-1	Marathon	D	30.9	80.94	130.98	156	187.28	656.4	8/27/2015	1	218.18
5760	Stratford Municipal Water and Electric Utility	Mg-1R	Marathon	D	33	81	129	153	183	633	7/19/2017		216
1250	City of Colby Municipal Water Utility	Mg-1	Marathon	D	41.13	78.21	115.29	133.83	157.01	482.13	11/15/2025		198.14
3420	Marshfield Utilities	Mg-1	Marathon	AB	30	71.92	113.84	134.8	161	554	5/1/2025		191
6300	Wausau Water Utility	Mg-1R	Marathon	AB	25.65	70.29	114.93	137.25	165.15	583.65	7/1/2023		190.8
2483	Village of Hatley Water Utility	Mg-1	Marathon	D	46.22	52.39	89.41	107.92	131.06	382.27	1/1/2026		177.28
3890	Mosinee Municipal Water And Sewer Utility	Mg-1	Marathon	C	36	69.36	102.72	119.4	140.25	427.8	4/1/2022	1	176.25
3350	Village of Water Marathon and Sewer Utility	Mg-1	Marathon	D	34.5	65.1	95.7	111	130.13	390	4/1/2016		164.63
5180	Rothschild Municipal Water Utility	Mg-1	Marathon	C	31.38	62.4	93.42	108.93	128.32	419.13	10/1/2023		159.7
260	Athens Municipal Water Utility	Mg-1	Marathon	D	25.56	58.08	90.6	106.86	127.19	415.26	10/1/2023		152.75
5290	Schofield Municipal Water and Sewer Utility	Mg-1	Marathon	C	33	59.28	85.56	98.7	115.13	351.6	9/12/2024		148.13
1750	Edgar Municipal Water Utility	Mg-1	Marathon	D	26.05	53.65	81.25	95.05	112.3	350.7	1/1/2024	1	138.35
6420	Weston Water Utility	Mg-1R	Marathon	AB	27.09	43.77	62.11	72.94	86.48	325.54	10/15/2023		113.57
5045	Rib Mountain Water Utility	Mg-1	Marathon	C	30	43.62	57.24	64.05	72.56	200.25	12/1/2025		102.56
2901	Kronenwetter Water Utility	Mg-1	Marathon	C	16.2	37.74	59.28	70.05	82.91	275.85	12/20/1999	1	99.11

Sheet 2- AB Class Utilities (4,000 or more customers)

Utility ID	Utility Name	Rate Schedule	County	Utility Class	Minimum Quarterly Bill (0.625 inch meter)	6000 GAL	12000 GAL	15000 GAL	18750 GAL	75000 GAL	Effective Date	Footnote	F+J
1800	Elkhorn Light And Water	Mg-1	Walworth	AB	33	107.24	181.48	218.6	265	937	3/1/2024		298
6240	City of Waukesha Water Utility	Mg-1R2	Waukesha	AB	60	115.98	171.96	199.95	234.94	1058.9	10/1/2024		294.94
5820	Superior Water Light And Power Company	Mg-1R	Douglas	AB	60	110.16	160.32	185.4	216.75	687	1/1/2025		276.75
3560	Menasha Electric and Water Utilities	Mg-1	Winnebago	AB	42	99.78	157.56	186.45	222.56	754.65	6/1/2024		264.56
2620	Village of Howard Water and Sewer Department	Mg-1R	Brown	AB	50.7	91.8	132.9	153.45	179.14	564.45	1/20/2021		229.84
2800	Kaukauna Utilities	Mg-1	Outagamie	AB	38.94	86.78	134.62	158.54	188.44	611.42	8/1/2025		227.38
1610	De Pere Water Department	Mg-1	Brown	AB	33	82.08	131.16	155.7	186.38	632	6/1/2024		219.38
5590	South Milwaukee Water Utility	Mg-1	Milwaukee	AB	37.5	82.46	127.42	149.9	178	599.5	7/28/2025		215.5
4480	City of Oshkosh Water Utility	Mg-1	Winnebago	AB	29.82	78.62	127.42	151.82	182.32	618.62	6/1/2023		212.14
70	Village of Allouez Water Department	Mg-1R	Brown	AB	34.5	72.6	120.3	144.15	173.96	726.9	1/1/2022		208.46
2010	Fond Du Lac Water Utility	Mg-1	Fond du Lac	AB	44	81.92	119.84	138.8	162.5	511	1/6/2023		206.5
4780	Port Washington Municipal Water Utility	Mg-1	Ozaukee	AB	27	73.16	119.32	142.4	171.25	582.4	9/1/2023		198.25
4340	City of Oconomowoc Utilities	Mg-1	Waukesha	AB	42.6	78.18	113.76	131.55	153.79	487.35	10/15/2025		196.39
2310	Town of Grand Chute Sanitary District 1	Mg-1	Outagamie	AB	21	69.84	118.68	143.1	173.63	622.95	7/1/2024		194.63
3420	Marshfield Utilities	Mg-1	Wood	AB	30	71.92	113.84	134.8	161	554	5/1/2025		191
6300	Wausau Water Utility	Mg-1R	Marathon	AB	25.65	70.29	114.93	137.25	165.15	583.65	7/1/2023		190.8
5990	Two Rivers Water and Light Utility	Mg-1	Manitowoc	AB	40.5	75.46	110.42	127.9	149.75	477.5	9/1/2023		190.25
3280	Madison Water Utility	Mg-1R	Dane	AB	42	69.6	101.7	120	143.85	783.45	3/1/2023		185.85
2260	Glendale Water Utility	Mg-1	Milwaukee	AB	30	68.52	107.04	126.3	150.38	508.75	6/20/2024		180.38
2470	City of Hartford Utilities	Mg-1	Washington	AB	40.5	70.2	99.9	114.75	133.31	411.45	1/8/2011	1	173.81
3370	Marinette Municipal Water Utility	Mg-1	Marinette	AB	27.9	65.5	103.1	121.9	145.4	488	4/21/2015	1	173.3
6320	Wauwatosa Water Utility	Mg-1	Milwaukee	AB	20	61.6	103.2	124	150	540	8/7/2023		170
430	Bellevue Water Utility	Mg-1	Brown	AB	28.74	64.32	99.9	117.69	139.93	473.49	7/20/2015	1,3	168.67
4730	Village of Pleasant Prairie Water Utility	Mg-1R	Kenosha	AB	45.03	70.17	95.31	107.88	123.59	359.28	5/1/2022		168.62
6230	Watertown Water Department	Mg-1	Jefferson	AB	27	62.28	97.56	115.2	137.25	439.6	8/2/2025		164.25
3595	Mequon Municipal Water Utility	Mg-1	Ozaukee	AB	31.32	63.06	94.8	110.67	130.51	428.07	12/18/2023		161.83
6700	Wisconsin Rapids Water Works and Lighting Commission	Mg-1R	Wood	AB	26.97	60.73	94.49	111.37	132.47	448.97	9/1/2024		159.44
190	Appleton Water Department	Mg-1	Calumet	AB	21.9	58.38	94.86	113.1	135.9	477.9	1/1/2018		157.8
400	Beaver Dam Water Utility	Mg-1	Dodge	AB	21.15	57.95	94.75	113.15	136.15	467.95	1/31/2025		157.3
180	Antigo Utilities	Mg-1R	Langlade	AB	33	60.92	88.84	102.8	120.25	382	10/1/2025		153.25
4030	City of Neenah Water Utility	Mg-1	Winnebago	AB	21	55.86	90.72	108.15	129.94	456.75	1/1/2011	1	150.94
4625	City of Pewaukee Water Utility	Mg-1	Waukesha	AB	30	58.5	87	101.25	119.06	386.25	3/1/2024		149.06
5780	Sturgeon Bay Utilities	Mg-1	Door	AB	30.9	58.38	85.86	99.6	116.78	365.4	8/1/2025		147.68
2105	Franklin Municipal Water Utility	Mg-1R	Milwaukee	AB	25.22	55.46	86.1	101.82	121.47	438.22	6/23/2016	1,3	146.69
255	Ashwaubenon Water And Sewer Utility	Mg-1	Brown	AB	24.81	55.59	86.37	101.76	121	409.56	3/18/2025		145.81
1000	Cedarburg Light And Water Commission	Mg-1	Ozaukee	AB	33.3	58.5	83.7	96.3	112.05	348.3	4/1/2023		145.35
5750	Stoughton Water Utility	Mg-1R	Dane	AB	39	60.48	81.96	92.7	106.13	307.5	7/1/2025		145.13
2360	Village of Greendale Water Utility	Mg-1	Milwaukee	AB	22.5	54.24	85.98	101.85	121.69	413.85	1/1/2025		144.19
4090	New Berlin Water Utility	Mg-1	Waukesha	AB	21	53.7	86.4	102.75	123.19	424.95	4/1/2024		144.19
5810	Sun Prairie Utilities	Mg-1R	Dane	AB	42	61.04	80.08	89.6	101.5	280	11/12/2025		143.5
900	Village of Caledonia Water Utility	Mg-1	Racine	AB	22.09	51.05	80.01	94.49	112.59	384.09	3/15/2021		134.68
2300	Grafton Water and Wastewater Utility	Mg-1R	Ozaukee	AB	29.7	53.16	76.62	88.35	103.01	322.95	9/20/2025		132.71
760	Brookfield Municipal Water Utility	Mg-1R	Waukesha	AB	20.7	47.7	75.86	91.1	110.15	413.45	12/1/2025		130.85
2060	City of Fort Atkinson Water Utility	Mg-1	Jefferson	AB	21.71	49.23	76.75	90.51	107.71	271.36	7/1/2024		129.42
2350	Green Bay Water Utility	Mg-1	Brown	AB	27	51	75	87	102	327	8/1/2024		129
4005	City of Muskego Water Public Utility	Mg-1	Waukesha	AB	28.96	51.4	73.84	85.06	99.09	288.31	1/1/2025		128.05
2210	Germantown Water Utility	Mg-1	Washington	AB	21	47.1	73.2	86.25	102.56	347.25	12/15/2024		123.56
4900	Racine Water Works Commission	Mg-1	Racine	AB	22.3	47.18	72.06	84.5	100.05	333.3	10/26/2020		122.35
5610	Sparta Municipal Water Department	Mg-1	Monroe	AB	28.65	49.45	70.25	80.65	93.65	283.75	2/15/2024		122.3
5365	City of Shawano Water and Sewer Utility	Mg-1	Shawano	AB	28.2	49	69.8	80.2	93.2	262.7	12/31/2023		121.4
6360	West Allis Municipal Water Utility	Mg-1	Milwaukee	AB	22.8	46.48	70.16	82	96.8	318.8	2/1/2025		119.6
4310	Oak Creek Water and Sewer Utility	Mg-1	Milwaukee	AB	27.58	47.92	68.26	78.43	91.14	281.83	11/15/2017		118.72
6480	Village of Whitefish Bay Water Utility	Mg-1	Milwaukee	AB	27.81	47.97	68.13	78.21	90.81	279.81	12/1/2025		118.62
1545	Darboy Joint Sanitary District No 1	Mg-1	Outagamie	AB	18	44.16	70.32	83.4	99.75	345	9/24/2021		117.75
6380	City of West Bend Water Utility	Mg-1	Washington	AB	21	44.92	68.84	80.8	95.75	320	10/1/2025		116.75
3140	Little Chute Municipal Water Department	Mg-1	Outagamie	AB	19.11	43.95	68.79	81.21	96.74	312.96	9/29/2015	1	115.85
360	City of Baraboo Water Utility	Mg-1	Sauk	AB	25.03	45.79	66.55	76.93	89.91	278.16	1/1/2026		114.94
6420	Weston Water Utility	Mg-1R	Marathon	AB	27.09	43.77	62.11	72.94	86.48	325.54	10/15/2023		113.57
4140	New Richmond Municipal Water Utility	Mg-1R	Saint Croix	AB	36	48.9	61.8	68.25	76.31	193.89	2/24/2021		112.31
1740	Eau Claire Municipal Water Utility	Mg-1R	Chippewa	AB	23.61	43.53	63.45	73.41	85.86	272.61	2/1/2025		109.47
6100	Verona Water Utility	Mg-1R	Dane	AB	21	41.88	62.76	73.2	86.25	282	9/16/2019		107.25
4410	Onalaska Municipal Water Utility	Mg-1R	La Crosse	AB	20.24	41.2	62.16	72.64	85.74	282.24	1/1/2025		105.98
3720	Milwaukee Water Works	Mg-1R	Milwaukee	AB	21.22	41.46	61.7	71.82	84.47	274.22	8/1/2025		105.69
3580	Village of Menomonee Falls Water Utility	Mg-1	Ozaukee	AB	11.52	37.38	63.24	76.17	92.33	309.97	1/1/2017		103.85
4440	Oregon Municipal Water And Sewer Utility	Mg-1	Dane	AB	21	40.08	59.16	68.7	80.63	236.1	10/31/2023		101.63
3820	Monroe Municipal Water Utility	Mg-1	Green	AB	21.06	39.54	58.02	67.26	78.81	239.26	12/5/2023		99.87
4737	Village of Plover Municipal Water Utility	Mg-1	Portage	AB	18	37.98	57.96	67.95	80.44	267.3	4/1/2022		98.44
1120	Chippewa Falls Department of Public Utilities	Mg-1	Chippewa	AB	22.5	39.54	56.58	65.1	75.75	223.6	1/2/2025		98.25
2980	Lake Geneva Utility Commission	Mg-1	Walworth	AB	19.1	38.22	57.34	66.9	78.85	258.1	12/9/2019		97.95
2740	Janesville Water Utility	Mg-1R	Rock	AB	16.34	34.58	53.53	65.49	80.44	356.29	9/1/2024		96.78
1480	City of Cudahy Water Utility	Mg-1R	Milwaukee	AB	19.65	37.65	56.65	64.65	75.9	244.65	2/1/2022		95.55
5690	Stevens Point Municipal Water Utility	Mg-1R	Portage	AB	29.66	41.18	52.7	58.46	65.66	173.66	12/1/2021		95.32
5370	Sheboygan Water Utility	Mg-1	Sheboygan	AB	15.78	36.02	56.26	66.38	79.03	268.78	4/1/2025		94.81
3590	City of Menomonie Water Department	Mg-1R	Dunn	AB	15.54	35.62	55.7	65.74	78.29	266.54	9/1/2023		93.83
6260	Waukegan Water And Light Commission	Mg-1	Dane	AB	20.25	36.15	52.05	60	69.94	208.2	12/1/2015	1	90.19
2820	Kenosha Water Utility	Mg-1	Kenosha	AB	15.86	34.5	53.14	62.46	74.11	242.98	7/3/2025		89.97
5110	River Falls Municipal Utility	Mg-1R	Saint Croix	AB	26.7	36.96	47.22	54.33	63.22	278.84	2/3/2025		89.92

Utility ID	Utility Name	Rate Schedule	County	Utility Class	Minimum Quarterly Bill (0.625 inch meter)	6000 GAL	12000 GAL	15000 GAL	18750 GAL	75000 GAL	Effective Date	Footnote	F+J
1990	Fitchburg Water Utility	Mg-1R	Dane	AB	18	32.64	48.76	57.19	69.38	288.94	3/16/2024		87.38
3640	Middleton Municipal Water Utility	Mg-1R	Dane	AB	17.74	33.88	50.02	58.09	68.18	219.49	12/15/2025		85.92
2920	La Crosse Water Utility	Mg-1R	La Crosse	AB	23.31	32.19	44.91	51.27	59.22	178.47	10/2/2019		82.53
3320	Manitowoc Public Utilities	Mg-1	Manitowoc	AB	16.35	31.95	47.55	55.35	65.1	206.75	12/1/2023		81.45
455	Beloit Water Utility	Mg-1R	Rock	AB	21	33.16	45.32	51.4	59	173	5/1/2017	1	80
2630	Hudson Public Utilities	Mg-1R	Saint Croix	AB	16.2	30.92	45.64	53	62.2	200.2	10/1/2021		78.4

Sheet 3- Water Utilities in the State

Utility ID	Utility Name	Rate Schedule	County	Utility Class	Minimum Quarterly Bill (0.625 inch meter)	6000 GAL	12000 GAL	15000 GAL	18750 GAL	75000 GAL	Effective Date	Footnote	J+F
6819	Town of Yorkville Water Utility	Mg-1	Racine	D	312.3	324.78	337.26	343.5	351.3	468.3	1/1/2025		663.6
6578	Winnebago Area Sanitary District	Mg-1	Winnebago	D	117	225.4	333.8	388	455.75	1472	4/19/2024		572.75
3345	Maplewood Sanitary District No 1	Mg-1	Door	D	141.6	232.02	322.44	367.65	424.16	1271.85	10/1/2024		565.76
3295	Village of Maiden Rock Municipal Water Utility	Mg-1	Pierce	D	96	197.88	299.76	350.7	414.38	1369.5	9/25/2025		510.38
1395	Country Estates Sanitary District	Mg-1	Walworth	D	117.12	186.66	256.2	290.97	334.43	986.37	1/1/2018	2	451.55
1780	Eleva Municipal Water Utility	Mg-1	Trempealeau	D	69	160.92	252.84	298.8	356.25	1095	10/1/2025		425.25
5830	Village of Suring Water Utility	Mg-1	Oconto	D	51.84	148.08	244.32	292.44	352.59	1104.09	9/1/2025		404.43
90	Alma Center Water Utility	Mg-1	Jackson	D	66	149.4	232.8	274.5	326.63	986.1	4/21/2025		392.63
920	Cambridge Municipal Water Utility	Mg-1	Dane	D	66	148.5	231	272.25	323.81	1093.68	5/1/2024		389.81
570	Blanchardville Municipal Water Utility	Mg-1R	Iowa	D	66	144.66	223.32	262.65	311.81	1049.25	8/1/2023		377.81
4490	Osseo Municipal Water And Sewer Utility	Mg-1	Trempealeau	D	51	138.96	226.92	270.9	325.88	950.25	5/1/2022		376.88
6470	Weyerhaeuser Municipal Water Utility	Mg-1	Rusk	D	58.5	136.5	214.5	253.5	302.25	921	7/1/2021		360.75
3080	La Valle Municipal Water Utility	Mg-1	Sauk	D	45	130.5	216	258.75	312.19	930	12/17/2024		357.19
5683	Stetsonville Water Utility	Mg-1	Taylor	D	51.84	132.84	213.84	254.34	304.97	894.24	1/4/2024	1	356.81
2410	Gresham Municipal Water And Sewer Utility	Mg-1	Shawano	D	46.98	130.74	214.5	256.38	308.73	864.48	10/15/2025		355.71
3136	Lincoln Sanitary District #1	Mg-1	Trempealeau	D	60	134.88	209.76	247.2	294	996	5/25/2023		354
3130	Linden Municipal Water Utility	Mg-1	Iowa	D	57	133.2	209.4	247.5	295.13	887.1	2/20/2024		352.13
6385	Westboro San Dist Wtr system	Mg-1	Taylor	D	66	133.98	201.96	235.95	278.44	915.75	1/1/2026		344.44
2780	Junction City Water Utility	Mg-1	Portage	D	61.56	139.98	218.4	257.61	282.32	642.21	4/1/2024		343.88
395	Bear Creek Water Utility	Mg-1	Outagamie	D	69	134.4	199.8	232.5	273.38	886.5	8/28/2019		342.38
615	Village of Blue Mounds Municipal Water Utility	Mg-1	Dane	D	46.2	125.4	204.6	244.2	293.7	1036.2	2/20/2025		339.9
3298	Maine Water Utility	Mg-1	Marathon	D	57.06	125.16	193.26	227.31	269.87	908.31	1/1/2022		326.93
5150	Rock Springs Municipal Utility	Mg-1	Sauk	D	51	122.82	194.64	230.55	275.44	948.75	1/25/2022		326.44
3340	Village of Maple Bluff Municipal Water Utility	Mg-1	Dane	D	54	122.8	191.6	226	269	914	12/26/2023		323
240	Arlington Water Utility	Mg-1	Columbia	D	54	122.46	190.92	225.15	267.94	909.75	6/28/2022		321.94
2490	Hawkins Municipal Water And Sewer Utility	Mg-1	Rusk	D	45	119.1	193.2	230.25	276.56	971.25	6/30/2024		321.56
2640	City of Hurley Water Utility	Mg-1	Iron	D	42.12	116.64	191.16	228.42	275	947.07	3/7/2024		317.12
2230	Gilman Water Utility	Mg-1	Taylor	D	60	121.2	182.4	213	251.25	675	12/20/2022		311.25
3620	Merrillan Municipal Electric and Water Utility	Mg-1R	Jackson	D	51.42	117.6	183.78	216.87	258.23	878.67	11/20/2025	1	309.65
2650	Hustisford Utilities	Mg-1	Dodge	D	70.14	123.6	177.06	203.79	237.2	734.61	1/1/2026		307.34
4950	Readstown Municipal Water Utility	Mg-1	Vernon	D	48	115.08	182.16	215.7	257.63	886.5	12/22/2025		305.63
6580	Winneconne Water Utility	Mg-1R	Winnebago	C	45	113.1	181.2	215.25	257.81	896.25	6/15/2024		302.81
4980	Reedsville Municipal Water Utility	Mg-1	Manitowoc	D	48	114	180	213	254.25	838.25	6/25/2021		302.25
3540	Melrose Municipal Water Utility	Mg-1	Jackson	D	68.97	120.99	173.01	199.02	231.53	660.47	6/1/2022		300.5
1890	Fairchild Municipal Water Utility	Mg-1	Eau Claire	D	54.08	115.58	177.08	207.83	246.27	776.48	1/1/2026		300.35
250	Ashland Water Utility	Mg-1	Ashland	C	45	111.8	178.6	212	253.75	880	12/11/2025		298.75
4080	New Auburn Municipal Water Utility	Mg-1	Barron	D	52.23	114.27	176.31	207.33	246.11	739.53	10/1/2024		298.34
6730	Withee Municipal Water Utility	Mg-1	Clark	D	63	118.08	173.16	200.7	235.13	751.5	12/5/2025		298.13
1800	Elkhorn Light And Water	Mg-1	Walworth	AB	33	107.24	181.48	218.6	265	937	3/1/2024		298
4550	Park Falls Municipal Water Utility	Mg-1	Price	C	37.85	108.59	179.33	214.7	258.91	898.65	9/22/2025		296.76
1870	Etrick Municipal Water And Sewer Utility	Mg-1	Trempealeau	D	67.98	118.38	168.78	193.98	225.48	605.28	8/1/2025		293.46
6240	City of Waukesha Water Utility	Mg-1R	Waukesha	AB	60	107.88	162.9	193.98	232.83	946.68	10/1/2024		292.83
3430	Mary Hill Park Sanitary District	Mg-1	Fond du Lac	D	74.27	119.39	164.51	187.07	215.27	638.27	8/15/2022		289.54
4510	Paddock Lake Municipal Water Utility	Mg-1	Kenosha	D	45	108.6	172.2	204	243.75	789.15	4/1/2023		288.75
6475	Village of Wheeler Municipal Water Utility	Mg-1	Dunn	D	60	113.1	166.2	192.75	225.94	723.75	9/30/2018		285.94
940	Campbellsport Municipal Water Utility	Mg-1	Fond du Lac	D	46.2	108	169.8	200.7	239.33	781.2	9/22/2017		285.53
2380	City of Greenwood Water Utility	Mg-1	Clark	D	40.6	105.88	171.16	203.8	244.6	795.85	10/16/2024		285.2
4570	Town of Pence Municipal Water Department	Mg-1	Iron	D	51.24	108.42	165.6	194.19	229.93	684.99	3/8/2019		281.17
5159	Town of Rome Water Utility	Mg-1	Adams	C	78	117.6	157.2	177	201.75	573	12/9/2007	1	279.75
5820	Superior Water Light And Power Company	Mg-1R	Douglas	AB	60	110.16	160.32	185.4	216.75	687	1/1/2025		276.75
4910	Radisson Water And Sewer Utility	Mg-1	Sawyer	D	45	104.64	164.28	194.1	231.38	790.5	12/26/2024		276.38
2320	Granton Municipal Water Utility	Mg-1	Clark	D	42.12	103.02	163.92	194.37	232.43	776.37	1/1/2024		274.55
3730	Town of Farmington Sanitary District	Mg-1	La Crosse	D	45	103.5	162	191.25	227.81	677.25	7/1/2025		272.81
955	Cascade Water Utility	Mg-1	Sheboygan	D	45	103.2	161.4	190.5	226.88	772.5	12/31/2025		271.88
2580	Hollandale Water Utility	Mg-1	Iowa	D	60	107.58	155.16	178.95	208.69	495.9	3/24/2025		268.69
6550	Wilton Municipal Water and Sewer Utility	Mg-1	Monroe	D	45	104.7	161.4	188.25	221.81	645.05	8/22/2021		266.81
1180	Cleveland Water Utility	Mg-1	Manitowoc	D	60	106.44	152.88	176.1	205.13	555.45	2/28/2024		265.13
3560	Menasha Electric and Water Utilities	Mg-1	Winnebago	AB	42	99.78	157.56	186.45	222.56	754.65	6/1/2024		264.56
5940	Trempealeau Municipal Electric and Water Utility	Mg-1	Trempealeau	D	43.26	99.18	155.1	183.06	218.01	708.78	7/1/2025		261.27
4670	Pittsville Municipal Water Utility	Mg-1	Wood	D	45	99.3	153.6	180.75	214.69	723.75	3/18/2025		259.69
810	Bruce Municipal Water and Sewer Utility	Mg-1	Rusk	D	36	95.7	155.4	185.25	222.56	719.25	1/1/2022		258.56
1360	Coon Valley Municipal Water Utility	Mg-1R	Vernon	D	51	100.74	150.48	175.35	206.44	672.75	6/30/2024		257.44
200	Applewood Hill Water Utility	Mg-1	Dane	D	45	97.68	150.36	176.7	209.63	703.5	1/5/2019		254.63
870	Butternut Municipal Water Department	Mg-1	Ashland	D	55.5	101.4	147.3	170.25	198.94	562.2	8/20/2025		254.44
2040	Footville Water Utility	Mg-1	Rock	D	39	95.34	151.68	179.85	215.06	707.25	6/20/2025		254.06
800	Browtown Municipal Water Utility	Mg-1	Green	D	46.35	97.95	149.55	175.35	207.6	624.03	3/22/2024		253.95
2570	Hixton Municipal Water Utility	Mg-1	Jackson	D	61.8	103.5	145.2	166.05	192.11	553.17	7/1/2015		253.91
1770	Elcho Sanitary District No 1	Mg-1	Langlade	D	42	95.7	149.4	176.25	209.81	675	2/28/2024		251.81

Utility ID	Utility Name	Rate Schedule	County	Utility Class	Minimum Quarterly Bill (0.625 inch meter)	6000 GAL	12000 GAL	15000 GAL	18750 GAL	75000 GAL	Effective Date	Footnote	J+F
670	Bowler Water And Sewer Utility	Mg-1	Shawano	D	50.16	98.46	146.76	170.91	201.1	616.91	1/2/2023	1	251.26
2150	Friesland Municipal Water Utility	Mg-1	Columbia	D	60	102	144	165	191.25	517.5	6/30/2014		251.25
6600	Wiotia Sanitary District Number One	Mg-1	Lafayette	D	45	96.48	147.96	173.7	205.88	565.25	6/25/2025		250.88
6590	Village of Winter Water Utility	Mg-1R	Sawyer	D	36	93	150	178.5	214.13	748.5	1/1/2023		250.13
1660	Village of Dorchester Water Utility	Mg-1	Marathon	D	54	99	144	166.5	194.63	578.25	9/26/2013		248.63
5840	Village of Taylor Water Utility	Mg-1	Jackson	D	51	97.5	144	167.25	196.31	542.25	4/16/2025		247.31
1850	Elroy Municipal Electric And Water Utility	Mg-1	Juneau	D	40.5	93.3	146.1	172.5	205.5	624	11/23/2022		246
1529	Dalton Sanitary District	Mg-1	Green Lake	D	49.8	96.6	143.4	166.8	196.05	634.8	10/8/2015		245.85
5620	Spencer Municipal Water Utility	Mg-1	Marathon	D	48	95.76	143.52	167.4	197.25	615.84	9/1/2023		245.25
3040	Land O Lakes Sanitary District No 1	Mg-1	Vilas	D	54	97.5	141	162.75	189.94	519	10/1/2021		243.94
490	Birchwood Municipal Water Utility	Mg-1	Washburn	D	45	94.2	143.4	168	198.75	583.75	10/1/2024		243.75
4800	Village of Pound Water and Sewer Utility	Mg-1	Marinette	D	36.9	90.84	144.78	171.75	205.46	711.15	6/30/2024		242.36
1600	Denmark Municipal Water Utility	Mg-1	Brown	C	51	95.16	139.32	161.4	189	580.75	3/15/2024		240
5545	Village of Somers Water Utility	Mg-1	Kenosha	C	51	94.92	138.84	160.8	188.25	568.5	6/1/2022		239.25
1550	Darien Water Works and Sewer System	Mg-1	Walworth	D	39.93	90.69	141.45	166.83	198.56	600.43	7/1/2025	1	238.49
50	Algoma Utility Commission	Mg-1	Kewaunee	C	65.01	99.69	134.37	151.71	173.39	472.41	10/31/2024		238.4
3095	Town of Lawrence Water Utility	Mg-1	Brown	C	36	89.1	142.2	168.75	201.94	671.67	8/1/2024		237.94
6505	Village of White Lake Water Utility	Mg-1	Langlade	D	43.8	91.74	139.68	163.65	193.61	643.05	12/20/2024		237.41
3960	Mount Sterling Municipal Water Utility	Mg-1	Crawford	D	36	88.92	141.84	168.3	201.38	653.85	4/1/2024		237.38
4500	Owen Municipal Water Utility	Mg-1	Clark	D	56.21	96.17	136.13	156.11	181.09	552.96	1/2/2025		237.3
2157	Fulton Water Utility	Mg-1	Rock	D	38.88	89.64	140.4	165.78	197.51	673.38	4/1/2024		236.39
5296	Town of Scott Water Utility	Mg-1	Brown	D	36	88.14	140.28	166.35	198.94	645.75	12/30/2024		234.94
5450	Village of Shorewood Hills Water Utility	Mg-1	Dane	D	35.82	87.98	140.14	166.22	198.82	687.82	5/30/2023		234.64
860	Butler Public Water Utility	Mg-1	Waukesha	D	51	93.18	135.36	156.45	182.81	549.05	5/21/2025		233.81
3180	Lomira Municipal Water Utility	Mg-1	Dodge	D	36	87.78	139.56	165.45	197.81	659.6	3/24/2025		233.81
610	Bloomington Municipal Water Utility	Mg-1	Grant	D	45	90.9	136.8	159.75	188.44	513	6/23/2025		233.44
5390	Town of Shelby Sanitary District #2	Mg-1	La Crosse	D	43.26	90.06	136.86	160.26	189.51	628.26	1/1/2026		232.77
4880	Princeton Municipal Water and Electric Utility	Mg-1	Green Lake	D	55.62	94.26	132.9	152.22	176.37	538.62	10/1/2015		231.99
620	Blue River Municipal Water And Sewer Utility	Mg-1	Grant	D	45.6	90	134.4	156.6	184.35	546.6	7/24/2025		229.95
2620	Village of Howard Water and Sewer Department	Mg-1R	Brown	AB	50.7	91.8	132.9	153.45	179.14	564.45	1/20/2021		229.84
1220	Cobb Municipal Water Utility	Mg-1	Iowa	D	51.15	91.95	132.75	153.15	178.65	461.7	11/3/2025		229.8
6500	Whitehall Municipal Water Utility	Mg-1	Trempealeau	D	39	87.48	135.96	160.2	190.5	624.84	1/1/2023		229.5
460	Benton Municipal Electric And Water Utility	Mg-1	Lafayette	D	42	88.48	134.96	158.2	187.25	577.78	1/1/2026		229.25
270	City of Augusta Municipal Water and Sewer Utility	Mg-1	Eau Claire	D	40.17	87.27	134.37	157.92	187.36	594.08	9/15/2025		227.53
6800	Village of Wrightstown Water Utility	Mg-1	Brown	C	43.26	88.38	133.5	156.06	184.26	605.01	6/1/2022	1, 3	227.52
2800	Kaukauna Utilities	Mg-1	Outagamie	AB	38.94	86.78	134.62	158.54	188.44	611.42	8/1/2025		227.38
1920	Fall Creek Municipal Water Utility	Mg-1	Eau Claire	D	36.3	85.62	134.94	159.6	190.43	606	1/1/2023		226.73
280	Avoca Municipal Water Utility	Mg-1	Iowa	D	40.83	87.09	133.35	156.48	185.39	562.38	12/21/2024		226.22
5420	Village of Sherwood Water and Sewer Utility	Mg-1	Calumet	C	55.65	92.19	128.73	147	169.84	512.4	9/1/2025		225.49
5090	Village of Ridgeway Municipal Water Utility	Mg-1	Iowa	D	54.69	91.77	128.85	147.39	170.57	465.54	7/29/2025		225.26
2530	Highland Municipal Water Utility	Mg-1	Iowa	D	51.78	90.48	129.18	148.53	172.72	444.75	7/1/2025		224.5
5880	Thorp Municipal Water And Sewer Utility	Mg-1	Clark	D	44.25	87.57	130.89	152.55	179.63	547.25	1/1/2022		223.88
4325	Village of Oakdale Water Utility	Mg-1	Monroe	D	40.5	86.16	131.82	154.65	183.19	516.75	5/1/2024		223.69
381	Village of Bay City Water Utility	Mg-1	Pierce	D	48	88.68	129.36	149.7	175.13	556.5	8/4/2025		223.13
385	Bayfield Water and Sewer Utility	Mg-1	Bayfield	D	56.73	91.71	126.69	144.18	166.04	493.98	2/6/2024		222.77
20	Adams Municipal Water And Sewer Utility	Mg-1	Adams	D	54	90.66	127.32	145.65	168.56	475.75	1/1/2026		222.56
4450	Orfordville Municipal Water Utility	Mg-1	Rock	D	51	89.52	128.04	147.3	171.38	466.5	9/6/2024		222.38
6820	Yuba Municipal Waterworks	Mg-1	Richland	D	24.72	80.04	135.36	163.02	197.6	716.22	1/5/2026		222.32
2940	Ladysmith Municipal Water Utility	Mg-1	Rusk	C	36.71	84.29	131.87	155.66	185.4	603.71	1/1/2026		222.11
1300	Columbus Water And Light Department	Mg-1	Dodge	C	45.06	86.98	128.9	149.86	176.06	555.2	9/1/2025		221.12
2288	Goodman Sanitary District #1	Mg-1	Marinette	D	30	81.42	132.84	158.55	190.69	672.75	6/30/2018		220.69
4120	City of New Lisbon Electric and Water Utility	Mg-1	Juneau	D	45.54	87	128.46	149.19	175.1	549.51	4/1/2025		220.64
2690	Iron Ridge Municipal Water Utility	Mg-1	Dodge	D	49.98	88.38	126.78	145.98	169.98	529.98	1/1/2025		219.96
5240	St Joseph Sanitary District #1	Mg-1	La Crosse	D	46.86	87.12	127.38	147.51	172.67	550.11	8/1/2024		219.53
1610	De Pere Water Department	Mg-1	Brown	AB	33	82.08	131.16	155.7	186.38	632	6/1/2024		219.38
990	Village of Cazenovia Water Utility	Mg-1	Sauk	D	39	84	129	151.5	179.63	546.5	10/1/2010		218.63
40	Albany Municipal Water And Sewer Utility	Mg-1	Green	D	43.86	89.22	134.58	152.43	174.74	509.43	2/1/2025		218.6
10	Abbotsford Municipal Water Utility	Mg-1	Marathon	D	30.9	80.94	130.98	156	187.28	656.4	8/27/2015	1	218.18
2020	Fontana Municipal Water Utility	Mg-1	Walworth	C	37.26	83.22	129.18	152.16	180.89	611.76	9/5/2023		218.15
6540	Williams Bay Municipal Water Utility	Mg-1	Walworth	C	37.5	83.28	129.06	151.95	180.56	609.75	10/6/2025		218.06
5600	South Wayne Municipal Water Utility	Mg-1	Lafayette	D	36.72	82.8	128.88	151.92	180.72	612.72	5/3/2024		217.44
6290	Waupun Public Utilities	Mg-1	Fond du Lac	C	41.46	84.18	126.9	148.26	174.96	568.75	5/1/2012	1	216.42
5760	Stratford Municipal Water and Electric Utility	Mg-1R	Marathon	D	33	81	129	153	183	633	7/19/2017		216
5590	South Milwaukee Water Utility	Mg-1	Milwaukee	AB	37.5	82.46	127.42	149.9	178	599.5	7/28/2025		215.5
3740	Mineral Point Municipal Water Utility	Mg-1	Iowa	C	46.35	86.75	127.15	147.35	169.04	481.04	10/1/2025		215.39
5720	Stoddard Municipal Water Utility	Mg-1	Vernon	D	38.88	82.92	126.96	148.98	176.51	491.48	3/22/2024		215.39
5395	Sheldon Municipal Water Utility	Mg-1	Rusk	D	48	86.16	124.32	143.4	167.25	525	4/1/2025		215.25
2340	Gratiot Municipal Water Utility	Mg-1	Lafayette	D	42.02	83.9	125.78	146.72	172.9	547.02	7/1/2025		214.92

Utility ID	Utility Name	Rate Schedule	County	Utility Class	Minimum Quarterly Bill (0.625 inch meter)	6000 GAL	12000 GAL	15000 GAL	18750 GAL	75000 GAL	Effective Date	Footnote	J+F
2600	City of Horicon Water Utility	Mg-1	Dodge	C	33	80.4	127.8	151.5	181.13	547.5	2/1/2025		214.13
4050	Nekoosa Municipal Water Utility	Mg-1	Wood	C	30.9	79.44	127.98	152.25	182.59	637.65	1/1/2017	1	213.49
5870	Theresa Municipal Water And Sewer Utility	Mg-1	Dodge	D	51.03	86.67	122.31	140.13	162.41	397.53	8/29/2025		213.44
30	Adell Municipal Sewer And Water Utility	Mg-1	Sheboygan	D	39	82.2	125.4	147	174	528	10/29/2024		213
4480	City of Oshkosh Water Utility	Mg-1	Winnebago	AB	29.82	78.62	127.42	151.82	182.32	618.62	6/1/2023		212.14
6760	Wonewoc Electric and Water Utility	Mg-1	Juneau	D	36	81	126	148.5	175.73	530.1	10/23/2017		211.73
5000	Rewey Municipal Water Utility	Mg-1	Iowa	D	35.73	80.61	125.49	147.93	175.98	545.43	11/1/2025		211.71
2700	Iron River Sanitary District No 1	Mg-1	Bayfield	D	39	81.72	124.44	145.8	172.5	541.41	7/1/2021		211.5
790	Brownsville Water Utility	Mg-1	Dodge	D	46.39	84.19	121.99	140.89	164.52	513.49	1/20/2025		210.91
1595	Delafield Municipal Water Utility	Mg-1	Waukesha	D	51	85.8	120.6	138	159.75	486	9/5/2025		210.75
350	Bangor Municipal Utility	Mg-1	La Crosse	D	39	81.36	123.72	144.9	171.38	541.72	2/1/2022		210.38
5650	Spring Valley Waterworks	Mg-1	Pierce	D	30	78	126	150	180	566.75	9/27/2021		210
3150	Livingston Municipal Water Utility	Mg-1	Iowa	D	37.5	80.4	123.3	144.75	171.56	573.75	1/3/2022		209.06
70	Village of Allouez Water Department	Mg-1R	Brown	AB	34.5	72.6	120.3	144.15	173.96	726.9	1/1/2022		208.46
5730	Stone Lake Sanitary District	Mg-1	Washburn	D	36	79.44	122.88	144.6	171.75	579	4/1/2024		207.75
3545	Melvina Municipal Water Utility	Mg-1	Monroe	D	30.03	77.23	124.43	148.03	177.53	604.63	12/15/2023		207.56
51	Algoma Sanitary District No 1	Mg-1	Winnebago	C	53.83	85.63	117.43	133.33	153.21	451.33	10/1/2025		207.04
4290	Norwalk Municipal Water Utility	Mg-1	Monroe	D	40.02	80.52	121.02	141.27	166.58	525.02	3/31/2021		206.6
2010	Fond Du Lac Water Utility	Mg-1	Fond du Lac	AB	44	81.92	119.84	138.8	162.5	511	1/6/2023		206.5
510	Biron Municipal Water Utility	Mg-1	Wood	D	36.78	79.26	121.74	142.98	169.53	523.98	8/13/2024		206.31
1590	Delavan Water and Sewage Commission	Mg-1	Walworth	C	39	79.56	120.12	140.4	165.08	495.08	1/1/2026		204.08
2660	Independence Municipal Water Utility	Mg-1	Trempealeau	D	35.01	77.67	120.33	141.66	168.32	544.41	11/1/2020	1	203.33
3630	Merrimac Municipal Water Utility	Mg-1	Sauk	D	42.12	79.68	117.24	136.02	159.5	511.62	7/26/2023		201.62
3210	Loyal Municipal Water Utility	Mg-1	Clark	D	34.5	76.8	119.1	140.25	166.69	522.75	1/1/2020		201.19
1615	Ledgeview Sanitary District No 2	Mg-1	Brown	C	38.25	78.09	117.93	137.85	162.75	536.25	3/21/2025		201
1535	Danbury Sanitary District	Mg-1	Burnett	D	47.04	80.88	114.72	131.64	152.79	470.04	9/29/2022	1	199.83
4225	Northfield Sanitary District No 1	Mg-1	Jackson	D	47.4	81	114.6	131.4	152.4	435.9	9/30/2014	1	199.8
2960	La Farge Municipal Water And Sewer Utility	Mg-1	Vernon	D	46.44	80.52	114.6	131.64	152.94	463.94	2/1/2025		199.38
1860	Embarrass Water And Sewer Utility	Mg-1	Waupaca	D	39	77.82	116.64	136.05	160.31	462.6	9/20/2024		199.31
6020	Union Grove Municipal Water Utility	Mg-1	Racine	C	33	75.54	118.08	139.35	165.94	556	4/1/2023		198.94
4780	Port Washington Municipal Water Utility	Mg-1	Ozaukee	AB	27	73.16	119.32	142.4	171.25	582.4	9/1/2023		198.25
1250	City of Colby Municipal Water Utility	Mg-1	Marathon	D	41.13	78.21	115.29	133.83	157.01	482.13	11/15/2025		198.14
4890	Pulaski Water Department	Mg-1	Brown	C	39	77.4	115.8	135	159	519	9/18/2025		198
2000	Florence Utility Commission	Mg-1	Florence	D	57.57	84.03	110.49	123.72	140.26	388.32	1/1/2024		197.83
1650	Dodgeville Water Utility	Mg-1	Iowa	C	33	75.18	117.36	138.45	164.81	531	1/16/2025		197.81
160	Village of Amherst Water Utility	Mg-1	Portage	D	38.19	77.01	115.83	135.24	159.5	490.14	4/29/2022		197.69
230	Argyle Municipal Electric and Water Utility	Mg-1	Lafayette	D	30.6	74.22	117.84	139.65	166.91	507	9/30/2025		197.51
2810	Kendall Municipal Water Utility	Mg-1	Monroe	D	40.62	79.56	116.82	134.61	156.85	463.29	2/16/2024		197.47
1690	Durand Municipal Water Utility	Mg-1	Pepin	D	45.9	79.62	113.34	130.2	151.28	467.4	9/1/2025		197.18
2655	Hustler Municipal Water Utility	Mg-1	Juneau	D	36	77.79	117.33	137.1	160.82	383.55	12/30/2024		196.82
930	Village of Cameron Municipal Water Utility	Mg-1R	Barron	D	33.72	75	116.28	136.92	162.72	549.72	12/30/2024		196.44
4340	City of Oconomowoc Utilities	Mg-1	Waukesha	AB	42.6	78.18	113.76	131.55	153.79	487.35	10/15/2025		196.39
3200	Lowell Municipal Water And Sewer Utility	Mg-1	Dodge	D	30.9	73.56	116.22	137.55	164.21	564.15	10/1/2025		195.11
2310	Town of Grand Chute Sanitary District 1	Mg-1	Outagamie	AB	21	69.84	118.68	143.1	173.63	622.95	7/1/2024		194.63
5330	Sharon Waterworks and Sewer system	Mg-1R	Walworth	D	40.47	69.45	108.57	128.13	152.58	519.33	3/21/2025		193.05
3170	Loganville Municipal Water and Sewer Utility	Mg-1	Sauk	D	45	77.82	110.64	127.05	147.56	455.25	8/15/2025		192.56
4240	North Freedom Municipal Water Utility	Mg-1	Sauk	D	31.59	72.99	114.39	135.09	160.97	533.14	1/1/2026		192.56
1685	Drummond Sanitary District 1	Mg-1	Bayfield	D	30	72	114	135	161.25	487.5	12/30/2013		191.25
3420	Marshfield Utilities	Mg-1	Wood	AB	30	71.92	113.84	134.8	161	554	5/1/2025		191
2680	Town of Knight Municipal Water Utility	Mg-1	Iron	D	36.45	74.19	111.93	130.8	154.39	487.3	12/1/2024		190.84
6300	Wausau Water Utility	Mg-1R	Marathon	AB	25.65	70.29	114.93	137.25	165.15	583.65	7/1/2023		190.8
5990	Two Rivers Water and Light Utility	Mg-1	Manitowoc	AB	40.5	75.46	110.42	127.9	149.75	477.5	9/1/2023		190.25
5860	Tennyson Water Utility	Mg-1R	Grant	D	36	73.74	111.48	130.35	153.94	507.75	7/1/2021		189.94
420	Belleville Municipal Water and Sewer Utility	Mg-1	Green	C	37.08	74.04	111	129.48	152.58	441.45	1/1/2026		189.66
5960	Troy Center Sanitary District #1	Mg-1	Walworth	D	24	69.24	114.48	137.1	165.38	589.5	2/2/2025		189.38
4330	Village of Oakfield Municipal Water Utility	Mg-1	Fond du Lac	D	30.79	71.53	112.27	132.64	158.1	497.69	1/1/2025		188.89
2973	Lake Como Sanitary District #1	Mg-1	Walworth	C	37.08	73.74	110.4	128.73	151.64	495.33	1/1/2026		188.72
3440	Mattoon Municipal Water Utility	Mg-1	Shawano	D	43.2	75.9	108.6	124.95	145.39	383.7	5/1/2012		188.59
310	Bagley Municipal Water Utility	Mg-1	Grant	D	34.5	72.72	110.94	130.05	153.94	512.25	4/21/2025		188.44
3460	Mayville Municipal Water Utility	Mg-1	Dodge	C	42	75.36	108.72	125.4	146.25	422.7	1/30/2025		188.25
2890	Kohler Municipal Water Utility	Mg-1	Sheboygan	D	40.57	74.73	108.89	125.97	147.32	467.57	9/15/2025		187.89
2200	Village of Genoa City Municipal Water Utility	Mg-1	Walworth	C	39	74.04	109.08	126.6	148.5	423.45	7/11/2002		187.5
5190	St Cloud Water and Sewer Utility	Mg-1	Fond du Lac	D	49.34	77.66	105.98	120.14	137.84	388.34	12/31/2019	1	187.18
1985	Fifield Sanitary District	Mg-1	Price	D	42	74.94	107.88	124.35	144.94	453.75	3/15/2025		186.94
3840	Montfort Municipal Water Utility	Mg-1	Iowa	D	45	75.9	106.8	122.25	141.56	399.75	12/15/2020		186.56
3280	Madison Water Utility	Mg-1R	Dane	AB	42	69.6	101.7	120	143.85	783.45	3/1/2023		185.85
585	City of Bloomer Water Utility	Mg-1	Chippewa	C	30	70.08	110.16	130.2	155.25	455.88	8/16/2023		185.25
3600	Mercer Sanitary District Number One	Mg-1	Iron	D	42.99	74.31	105.63	121.29	140.87	411.99	1/1/2026	1	183.86
2280	Glidden Sanitary District	Mg-1	Ashland	D	34.35	71.19	108.03	126.45	149.48	419.35	11/1/2024		183.83
3920	Mount Hope Municipal Water Utility	Mg-1	Grant	D	39.04	73.72	108.4	125.74	144.75	415.44	4/8/2025		183.79

Utility ID	Utility Name	Rate Schedule	County	Utility Class	Minimum Quarterly Bill (0.625 inch meter)	6000 GAL	12000 GAL	15000 GAL	18750 GAL	75000 GAL	Effective Date	Footnote	J+F
5520	Village of Soldiers Grove Municipal Water Utility	Mg-1	Crawford	D	42	73.8	105.6	121.5	141.38	439.5	8/29/2024		183.38
4600	Pepin Municipal Water Utility	Mg-1	Pepin	D	36	71.58	107.16	124.95	147.19	480.75	12/18/2020		183.19
480	Berlin Municipal Water And Sewer Utility	Mg-1	Waushara	C	36.9	72.02	107.14	124.7	146.02	428.02	3/29/2024		182.92
5910	Tigerton Municipal Water and Sewer Utility	Mg-1	Shawano	D	33.99	70.77	107.55	125.94	148.93	493.74	1/1/2022		182.92
6190	Washburn Municipal Water And Sewer Utility	Mg-1	Bayfield	D	34.74	70.92	107.1	125.19	147.8	388.49	9/16/2024	1	182.54
4100	New Glarus Light And Water Works	Mg-1	Green	D	43.5	73.92	104.34	119.55	138.56	415.65	1/30/2025		182.06
3000	Lake Mills Light And Water Department	Mg-1R	Jefferson	C	34.83	70.77	106.71	124.68	147.14	484.08	10/1/2023		181.97
2260	Glendale Water Utility	Mg-1	Milwaukee	AB	30	68.52	107.04	126.3	150.38	508.75	6/20/2024		180.38
1450	Cross Plains Water Utility	Mg-1R	Dane	C	30	68.28	106.56	125.7	149.63	508.5	7/10/2024		179.63
1370	Cornell Municipal Water And Electric Utility	Mg-1	Chippewa	D	27.87	67.23	106.59	126.27	150.87	485.22	1/16/2026		178.74
690	Boyd Municipal Water And Sewer Utility	Mg-1	Chippewa	D	31.23	68.37	105.51	124.08	147.29	418.73	4/17/2025		178.52
910	Cambria Municipal Water Utility	Mg-1	Columbia	D	36	69.9	103.8	120.75	141.94	410.25	3/22/2019		177.94
6560	Wind Point Municipal Water Utility	Mg-1	Racine	D	24	65.44	106.88	127.6	153.5	542	12/15/2025		177.5
3160	Lodi Municipal Light And Water Utility	Mg-1	Columbia	C	40.98	71.52	102.06	117.33	136.42	402.21	9/1/2024		177.4
2483	Village of Hatley Water Utility	Mg-1	Marathon	D	46.22	52.39	89.41	107.92	131.06	382.27	1/1/2026		177.28
6810	GREENLEAF WATER UTILITY	Mg-1	Brown	D	37.5	70.2	102.9	119.25	139.69	401.25	12/18/2024		177.19
1880	City of Evansville Water and Light	Mg-1	Rock	C	37.08	69.96	102.84	119.28	139.83	404.77	1/1/2026		176.91
3890	Mosinee Municipal Water And Sewer Utility	Mg-1	Marathon	C	36	69.36	102.72	119.4	140.25	427.8	4/1/2022	1	176.25
1050	Centuria Municipal Water And Sewer Utility	Mg-1	Polk	D	33.37	68.41	103.45	120.97	142.87	378.67	1/1/2024		176.24
3045	Lannon Municipal Water Utility	Mg-1	Waukesha	D	36	69.24	102.48	119.1	139.88	451.5	10/1/2023		175.88
4400	City of Omro Water Utility	Mg-1	Winnebago	C	36	69.24	102.48	119.1	139.88	451.5	7/1/2025		175.88
1280	Coloma Municipal Water Utility	Mg-1	Waushara	D	39.33	70.17	101.01	116.43	135.71	394.03	12/22/2025		175.04
1810	Elk Mound Municipal Water and Sewer Utility	Mg-1	Dunn	D	34.71	68.49	102.27	119.16	140.27	404.31	12/15/2025		174.98
4785	Port Wingtn Of Sanitary Dist	Mg-1	Bayfield	D	31.85	67.43	103.01	120.8	143.04	476.6	1/1/2025		174.89
970	Cashton Municipal Electric And Water Utility	Mg-1	Monroe	D	30	67.2	104.4	123	144.85	467.35	2/15/2018		174.85
1435	Village of Crivitz Water Utility	Mg-1R	Marinette	D	30.03	66.75	103.47	121.83	144.78	489.03	10/15/2025		174.81
627	Bluffview Sanitary District	Mg-1	Sauk	D	36.63	69.09	101.55	117.78	138.07	442.38	6/1/2017	2	174.7
2805	Kellnersville Water Utility	Mg-1	Manitowoc	D	35.38	68.44	101.5	118.03	138.69	448.63	1/1/2026		174.07
2470	City of Hartford Utilities	Mg-1	Washington	AB	40.5	70.2	99.9	114.75	133.31	411.45	1/8/2011	1	173.81
5670	Stanley Municipal Waterworks	Mg-1R	Clark	C	24	64.14	104.28	124.35	149.44	525.75	9/1/2017	1	173.44
3370	Marinette Municipal Water Utility	Mg-1	Marinette	AB	27.9	65.5	103.1	121.9	145.4	488	4/21/2015	1	173.3
6010	Village of Union Center Water Utility	Mg-1	Juneau	D	36	68.4	100.8	117	137.25	393.75	7/21/2024		173.25
4540	Pardeeville Municipal Water Utility	Mg-1	Columbia	D	38.25	69.15	100.05	115.5	134.81	360.75	11/21/2024		173.06
80	Alma Municipal Water Utility	Mg-1	Buffalo	D	30.36	65.96	101.56	119.36	141.61	433.86	3/1/2025		171.97
6220	Waterloo Water And Light Commission	Mg-1	Jefferson	C	38.88	68.7	98.52	113.43	132.07	411.63	9/1/2023		170.95
6335	Harrison Utilities	Mg-1	Calumet	C	35.85	67.41	98.97	114.75	134.48	430.35	5/21/2022		170.33
6320	Wauwatosa Water Utility	Mg-1	Waukesha	AB	20	61.6	103.2	124	150	540	8/7/2023		170
6572	Windsor Water Utility	Mg-1	Dane	C	45.3	70.56	95.82	108.45	124.24	359.25	3/21/2025		169.54
531	Village of Black Earth Water Utility	Mg-1	Dane	D	37.08	67.56	98.04	113.28	132.33	402.78	1/15/2026		169.41
430	Bellevue Water Utility	Mg-1	Brown	AB	28.74	64.32	99.9	117.69	139.93	473.49	7/20/2015	1, 3	168.67
3675	Village of Milladore Water Utility	Mg-1	Wood	D	34.08	66.24	98.4	114.48	134.58	427.08	1/1/2025		168.66
4730	Village of Pleasant Prairie Water Utility	Mg-1R	Kenosha	AB	45.03	70.17	95.31	107.88	123.59	359.28	5/1/2022		168.62
1570	Deerfield Water Utility	Mg-1	Dane	C	36	66.9	97.8	113.25	132.56	397.5	9/28/2017		168.56
5835	Village of Sussex Water Public Utility	Mg-1	Waukesha	C	40.17	68.31	96.45	110.52	128.11	391.92	1/1/2026		168.28
5770	Strum Municipal Utilities	Mg-1	Trempealeau	D	35.85	66.33	96.81	112.05	131.1	369.6	4/1/2025		166.95
2070	Fountain City Water Utility	Mg-1	Buffalo	D	40.08	67.8	95.52	109.38	126.71	339.28	12/23/2024		166.79
2090	Village of Fox Point Water Utility	Mg-1	Milwaukee	C	25.09	62.29	99.49	118.09	141.34	490.09	8/1/2025		166.43
5250	St Nazianz Water Utility	Mg-1R	Manitowoc	D	33	65.1	97.2	113.25	133.31	434.25	3/10/2023		166.31
2840	Kewaunee Municipal Water Utility	Mg-1R	Kewaunee	C	34.5	65.58	96.66	112.2	131.63	423	6/26/2023		166.13
3850	Village of Monticello Water Utility	Mg-1	Green	D	33.75	65.25	96.75	112.5	132.19	369.9	4/1/2016	1	165.94
710	Brillion Municipal Water Utility	Mg-1	Calumet	C	27	62.76	98.52	116.4	138.75	461.4	6/2/2025		165.75
5010	City of Rhinelander Water Utility	Mg-1	Oneida	C	39.75	67.35	94.95	108.75	126	372.5	1/1/2025		165.75
5715	Stockbridge Water Utility	Mg-1	Calumet	D	30	63.6	97.2	114	135	423	1/1/2020		165
6530	Whiting Municipal Water And Sewer Utility	Mg-1	Portage	D	21	60.36	99.72	119.4	144	495.5	9/17/2025		165
3350	Village of Water Marathon and Sewer Utility	Mg-1	Marathon	D	34.5	65.1	95.7	111	130.13	390	4/1/2016		164.63
6230	Watertown Water Department	Mg-1	Jefferson	AB	27	62.28	97.56	115.2	137.25	439.6	8/2/2025		164.25
4830	Prairie Du Sac Municipal Electric and Water	Mg-1	Sauk	C	33	64.26	95.52	111.15	130.69	409.8	7/1/2025		163.69
6140	City of Viroqua Municipal Water Utility	Mg-1	Vernon	C	26.04	61.72	97.4	115.24	137.54	472.04	11/1/2025	1	163.58
3550	Fox Crossing Utilities	Mg-1R	Calumet	AB	21.63	56.79	96.03	115.65	141.94	545.81	1/1/2026		163.57
630	Bonduel Water and Sewer Utility	Mg-1	Shawano	D	30	63.06	96.12	112.65	133.31	404.75	12/25/2021		163.31
4110	New Holstein Public Utility	Mg-1R	Calumet	C	32.4	63.9	95.4	111.15	130.84	426.15	10/1/2023		163.24
720	Bristol Water Utility	Mg-1	Kenosha	D	46.7	68.96	91.22	102.35	116.26	319.55	12/20/2025		162.96
4640	Phillips Municipal Water Works	Mg-1	Price	D	28.67	62.43	96.19	113.07	134.17	414.17	3/1/2025		162.84
6350	Village of Webster Municipal Water Utility	Mg-1	Burnett	D	32.25	63.69	95.13	110.85	130.5	390.6	6/26/2025		162.75
4040	City of Neillsville Municipal Water Utility	Mg-1	Clark	C	24.72	60.96	97.2	115.32	137.97	477.72	9/2/2025		162.69
4810	Poyntette Municipal Water Utility	Mg-1R	Columbia	C	27	61.68	96.36	113.7	135.38	460.5	12/29/2025		162.38
2080	City of Fox Lake Water Utility	Mg-1	Dodge	D	34.74	64.42	94.1	108.94	127.49	405.74	12/27/2025		162.23
3595	Mequon Municipal Water Utility	Mg-1	Ozaukee	AB	31.32	63.06	94.8	110.67	130.51	428.07	12/18/2023		161.83

Utility ID	Utility Name	Rate Schedule	County	Utility Class	Minimum Quarterly Bill (0.625 inch meter)	6000 GAL	12000 GAL	15000 GAL	18750 GAL	75000 GAL	Effective Date	Footnote	J+F
840	Burlington Municipal Waterworks	Mg-1	Racine	C	33	63.64	94.28	109.6	128.75	408.5	12/15/2025		161.75
1390	Cottage Grove Water and Sewer Utility	Mg-1R	Dane	C	34.8	63.66	92.52	107.82	126.95	458.19	4/1/2024		161.75
6790	Woodville Water And Sewer Utility	Mg-1R	Saint Croix	D	33.77	63.89	94.01	109.07	127.9	410.27	12/17/2025		161.67
5470	Shullsburg Water Utility	Mg-1	Lafayette	D	34.35	63.87	93.39	108.15	126.6	333.99	10/15/2024		160.95
3980	Mukwonago Municipal Water Utility	Mg-1	Waukesha	C	33.95	63.65	93.35	108.2	126.76	387.2	1/6/2022		160.71
3530	Mellen Municipal Water Utility	Mg-1	Ashland	D	42	66.48	90.96	103.2	118.5	285.9	3/16/2024		160.5
5935	Tony Municipal Water Utility	Mg-1	Rusk	D	37.48	65.56	93.64	107.68	122.91	351.28	7/1/2024		160.39
890	Cadott Light And Water Municipal Utility	Mg-1	Chippewa	D	31.05	62.43	93.81	109.5	129.11	370.2	8/20/2023		160.16
5550	Village of Somerset Water Utility	Mg-1	Saint Croix	C	33	63.12	93.24	108.3	127.13	387	3/16/2021		160.13
1200	Clintonville Water and Electric Utility	Mg-1	Waupaca	C	33.72	63.36	93	107.82	126.35	391.62	2/1/2025	1	160.07
5180	Rothschild Municipal Water Utility	Mg-1	Marathon	C	31.38	62.4	93.42	108.93	128.32	419.13	10/1/2023		159.7
560	Blair Municipal Water Utility	Mg-1	Trempealeau	D	37.08	64.38	91.68	105.33	122.39	373.38	1/1/2026		159.47
6700	Wisconsin Rapids Water Works and Lighting Commission	Mg-1R	Wood	AB	26.97	60.73	94.49	111.37	132.47	448.97	9/1/2024		159.44
4430	Oostburg Municipal Water Utility	Mg-1	Sheboygan	C	24.69	59.73	94.77	112.29	134.19	384.93	8/16/2025		158.88
3120	Lena Municipal Water and Sewer Utility	Mg-1	Oconto	D	41.7	65.82	89.94	102	117.08	331.05	3/16/2024		158.78
2550	Hillsboro Municipal Water Utility	Mg-1	Vernon	D	39	64.8	90.6	103.5	119.63	331.41	1/17/2025		158.63
410	Belgium Municipal Water Utility	Mg-1	Ozaukee	D	32.2	62.32	92.44	107.5	126.33	408.7	3/15/2025		158.53
3860	Montreat Municipal Water Utility	Mg-1	Iron	D	21	58.2	95.4	114	137.25	469.5	9/1/2018		158.25
4680	Plain Municipal Water Utility	Mg-1	Sauk	D	27.37	62.35	97.33	114.82	130.53	366.22	12/20/2023	1	157.9
190	Appleton Water Department	Mg-1	Winnebago	AB	21.9	58.38	94.86	113.1	135.9	477.9	1/1/2018		157.8
550	Black River Falls Municipal Electric and Water	Mg-1	Jackson	C	31.86	61.86	91.86	106.86	125.61	385.4	7/1/2024		157.47
400	Beaver Dam Water Utility	Mg-1	Dodge	AB	21.15	57.95	94.75	113.15	136.15	467.95	1/31/2025		157.3
1190	Clinton Municipal Waterworks	Mg-1	Rock	D	29.07	60.75	92.43	108.27	128.07	425.07	2/28/2023		157.14
4700	Platteville Water and Sewer Utility	Mg-1R	Grant	C	30.57	61.13	91.69	106.97	126.07	412.57	10/15/2025		156.64
700	Brandon Sewer and Water Utility	Mg-1R	Fond du Lac	D	30	60.9	91.8	107.25	126.56	416.25	5/15/2016		156.56
4610	Peshigo Municipal Water Utility	Mg-1	Marinette	C	33.42	62.1	90.78	105.12	123.05	383.92	12/20/2018	4	156.47
3830	City of Montello Water Utility	Mg-1	Marquette	C	31.95	61.29	90.63	105.3	123.64	368.61	9/1/2020		155.59
340	Balsam Lake Municipal Water Utility	Mg-1	Polk	D	31.2	60.6	90	104.7	123.08	379.1	9/21/2024		154.28
3800	Monona Water Utility	Mg-1R	Dane	C	33	58.08	86.91	101.7	121.25	478.44	7/1/2021		154.25
1260	Coleman Water Utility	Mg-1	Marinette	D	27	59.04	91.08	107.1	127.13	427.5	12/20/2023		154.13
180	Antigo Utilities	Mg-1R	Langlade	AB	33	60.92	88.84	102.8	120.25	382	10/1/2025		153.25
3135	Linden Tn Of Sanitary Dist #1	Mg-1	Iowa	D	27.99	59.07	90.15	105.69	125.12	361.92	1/12/2026	1	153.11
2573	Village of Hobart Water Utility	Mg-1	Brown	C	32.4	60.6	88.8	102.9	120.53	384.9	1/1/2024	3	152.93
260	Athens Municipal Water Utility	Mg-1	Marathon	D	25.56	58.08	90.6	106.86	127.19	415.26	10/1/2023		152.75
370	Barnesville Municipal Water Utility	Mg-1	Iowa	D	34.35	61.23	88.11	101.55	118.35	370.35	3/1/2021		152.7
1310	Combined Locks Water Utility	Mg-1	Outagamie	C	24.72	57.66	90.6	107.07	127.66	422.22	8/20/2019		152.38
1080	Chetek Municipal Water Utility	Mg-1	Barron	C	33	60.54	88.08	101.85	119.06	377.25	11/1/2024		152.06
2275	Village of Glen Flora Water Utility	Mg-1	Rusk	D	45.66	50.06	76.46	89.66	106.16	281.9	7/1/2023		151.82
4360	Oconto Falls Water And Light Commission	Mg-1	Oconto	C	29.94	59.22	88.5	103.14	121.44	371.93	2/1/2023	1	151.38
5130	Rockland Municipal Water And Sewer Utility	Mg-1	Monroe	D	29.94	59.16	88.38	102.99	121.25	395.19	4/1/2025		151.19
4030	City of Neenah Water Utility	Mg-1	Winnebago	AB	21	55.86	90.72	108.15	129.94	456.75	1/1/2011	1	150.94
5900	Three Lakes Sanitary District No 1	Mg-1	Oneida	D	41.1	62.94	84.78	95.7	109.35	314.1	9/1/2025		150.45
2510	Hazel Green Municipal Utility	Mg-1	Lafayette	D	34.17	60.41	86.65	99.77	116.17	332.09	11/15/2023		150.34
100	Almena Municipal Water Utility	Mg-1	Barron	D	25.35	57.21	89.07	105	124.91	322.35	4/1/2025		150.26
2703	Ironton Water Utility	Mg-1	Sauk	D	30	58.8	87.6	102	120	384.5	12/22/2024		150
950	Camp Douglas Municipal Water Utility	Mg-1	Juneau	D	39.15	62.07	84.99	96.45	110.78	305.67	6/30/2025		149.93
2752	Jefferson Water Utility	Mg-1	Jefferson	C	31.59	59.19	86.79	100.59	117.84	360.99	1/1/2024	1	149.43
6370	West Baraboo Municipal Water and Sewer Utility	Mg-1	Sauk	D	24.87	56.71	88.55	104.47	124.37	405.27	7/30/2024		149.24
4625	City of Pewaukee Water Utility	Mg-1	Waukesha	AB	30	58.5	87	101.25	119.06	386.25	3/1/2024		149.06
5030	Village of Rib Lake Water Utility	Mg-1	Taylor	D	26.48	56.96	87.44	102.68	121.73	378.23	3/17/2023		148.21
5290	Schofield Municipal Water and Sewer Utility	Mg-1	Marathon	C	33	59.28	85.56	98.7	115.13	351.6	9/12/2024		148.13
2135	Freedom Sanitary District No 1	Mg-1	Outagamie	C	31.74	58.74	85.74	99.24	116.12	369.24	6/16/2021		147.86
2450	Hancock Municipal Water Utility	Mg-1	Waushara	D	30.9	58.38	85.86	99.6	116.78	307.35	10/1/2025		147.68
4920	Randolph Municipal Water Utility	Mg-1	Dodge	D	30.9	58.38	85.86	99.6	116.78	328.32	1/2/2020		147.68
5780	Sturgeon Bay Utilities	Mg-1	Door	AB	30.9	58.38	85.86	99.6	116.78	365.4	8/1/2025		147.68
4775	Town of Portland Sanitary District #1	Mg-1	Dodge	D	30	58.02	86.04	100.05	117.56	380.25	11/1/2024		147.56
5400	Shell Lake Municipal Utilities	Mg-1	Washburn	D	32.69	58.91	85.13	98.24	114.63	360.44	4/3/2025		147.32
5105	Ripon Water Utility	Mg-1R	Fond du Lac	C	28.5	57.38	86.26	100.7	118.75	389.5	1/1/2026		147.25
5380	Sheboygan Falls Utilities	Mg-1	Sheboygan	C	32.19	58.65	85.11	98.34	114.88	362.19	12/30/2025		147.07
2105	Franklin Municipal Water Utility	Mg-1R	Milwaukee	AB	25.22	55.46	86.1	101.82	121.47	438.22	6/23/2016	1, 3	146.69
3125	Leroy Sanitary District No 1	Mg-1	Dodge	D	25.26	55.98	86.7	102.06	121.26	409.26	12/1/2025		146.52
1730	Village of East Troy Municipal Water Utility	Mg-1R	Walworth	C	24	55.5	87	102.75	122.44	417.75	3/16/2024		146.44
2045	Forest Junction Utilities	Mg-1	Calumet	D	28.49	57.05	85.61	99.89	117.74	385.49	1/5/2026		146.23
1980	Fennimore Water And Light Plant	Mg-1	Grant	C	28.74	57.12	85.5	99.69	117.43	378.09	7/26/2025	1	146.17
2170	Village of Gays Mills Municipal Water Utility	Mg-1	Crawford	D	24.72	55.62	86.52	101.97	121.28	396.21	1/1/2026	1	146
255	Ashwaubenon Water And Sewer Utility	Mg-1	Brown	AB	24.81	55.59	86.37	101.76	121	409.56	3/18/2025		145.81
5480	Siren Municipal Water Utility	Mg-1	Burnett	D	32.4	58.32	84.24	97.2	113.4	298.08	1/1/2024	1	145.8
2370	City of Green Lake Water Utility	Mg-1	Adams	D	33.99	58.83	83.67	96.09	111.62	320.34	9/19/2025		145.61
5200	St Croix Improvements Inc	Mg-1	Pierce	D	54	66	78	84	91.5	204	3/29/2019		145.5
1000	Cedarburg Light And Water Commission	Mg-1	Ozaukee	AB	33.3	58.5	83.7	96.3	112.05	348.3	4/1/2023		145.35
6325	Wautoma Public Water Utility	Mg-1	Waushara	C	40.8	61.2	81.6	91.8	104.55	275.55	5/31/2012	1	145.35
1270	Colfax Municipal Water And Sewer Utility	Mg-1	Dunn	D	29.36	57.02	84.68	98.51	115.8	337.31	1/2/2026		145.16

Utility ID	Utility Name	Rate Schedule	County	Utility Class	Minimum Quarterly Bill (0.625 inch meter)	6000 GAL	12000 GAL	15000 GAL	18750 GAL	75000 GAL	Effective Date	Footnote	J+F
5750	Stoughton Water Utility	Mg-1R	Dane	AB	39	60.48	81.96	92.7	106.13	307.5	7/1/2025		145.13
5220	St Croix Falls Municipal Water Utility	Mg-1	Polk	D	21.63	54.19	86.75	103.03	123.38	422.43	1/2/2026		145.01
5675	Star Prairie Municipal Water Utility	Mg-1	Saint Croix	D	30	57.18	84.36	97.95	114.94	369.75	7/1/2024		144.94
5440	Shorewood Municipal Water Utility	Mg-1	Milwaukee	C	30	57.04	84.08	97.6	114.5	368	1/6/2023		144.5
2360	Village of Greendale Water Utility	Mg-1	Milwaukee	AB	22.5	54.24	85.98	101.85	121.69	413.85	1/1/2025		144.19
4090	New Berlin Water Utility	Mg-1	Waukesha	AB	21	53.7	86.4	102.75	123.19	424.95	4/1/2024		144.19
1400	Crandon Water And Sewer Utility	Mg-1	Forest	D	35.3	58.82	82.34	94.1	108.8	290.15	10/1/2023		144.1
5430	Shiocton Municipal Utility	Mg-1	Outagamie	D	25.92	55.38	84.84	99.57	117.98	343.32	12/21/2023		143.9
1670	Dousman Water Utility	Mg-1R	Waukesha	D	36	58.98	81.96	93.45	107.81	323.25	9/30/2025		143.81
5320	Seymour Municipal Water Utility	Mg-1	Outagamie	C	28.2	56.16	84.12	98.1	115.58	370.5	4/28/2017		143.78
5377	Sheboygan Tn Of Sanitary Dist #3	Mg-1	Sheboygan	C	31.2	57.24	83.28	96.3	112.58	356.7	10/1/2025		143.78
4350	Oconto Utility Commission	Mg-1R	Oconto	C	31.5	57.26	83.02	95.9	112	353.5	12/10/2025		143.5
5810	Sun Prairie Utilities	Mg-1R	Dane	AB	42	61.04	80.08	89.6	101.5	280	11/12/2025		143.5
2140	Village of Friendship Water Utility	Mg-1	Adams	D	36	58.8	81.6	93	107.25	307	3/15/2010	1	143.25
210	Arcadia Electric and Water Utility	Mg-1	Trempealeau	C	39.18	59.88	80.58	90.93	103.87	289.77	1/31/2023		143.05
2575	Town of Holland Sanitary District #1	Mg-1	Brown	D	23.18	54.08	84.98	100.43	119.74	409.43	10/1/2025		142.92
5920	Tomah Water Utility	Mg-1	Monroe	C	25.68	54.96	84.24	98.88	117.18	391.68	1/1/2025	1	142.86
4460	Osceola Municipal Water Utility	Mg-1	Polk	C	24.72	54.56	84.4	99.32	117.97	340.99	1/13/2026		142.69
1710	Eagle River Light And Water Commission	Mg-1	Vilas	C	34.74	57.86	80.98	92.54	106.99	310.14	11/1/2025		141.73
5270	Saukville Municipal Water Utility	Mg-1	Ozaukee	C	31.72	56.68	81.64	94.12	109.72	318.97	1/1/2026	1	141.44
3490	Mcfarland Water and Sewer Utility	Mg-1	Dane	C	36	58.02	80.04	91.05	104.81	311.25	5/15/2024		140.81
1540	Dane Water and Sewer Utility	Mg-1	Dane	D	32.4	56.7	81	93.15	108.34	336.15	12/1/2023		140.74
2790	Juneau Utility Commission	Mg-1	Dodge	D	30	55.5	81	93.75	109.69	323.25	7/1/2020		139.69
3760	Village of Minong Water Utility	Mg-1	Washburn	D	40.69	59.35	78.01	87.34	99	256.34	4/1/2024		139.69
4740	Plymouth Utilities	Mg-1	Sheboygan	C	28.29	54.85	81.41	94.69	111.29	360.29	4/1/2023	1	139.58
3129	Liberty Grove Sanitary District No 1	Mg-1	Door	D	27	54.3	81.6	95.25	112.31	332.25	12/21/2019		139.31
4130	New London Electric and Water Utility	Mg-1	Waupaca	C	36.99	57.87	78.75	89.19	102.24	297.99	3/1/2024	1	139.23
1700	Village of Eagle Municipal Water Utility	Mg-1	Waukesha	D	33	56.4	79.8	91.5	106.13	307.5	1/1/2012		139.13
2428	Village of Lake Hallie Public Works	Mg-1	Chippewa	C	36	40.87	70.09	84.7	102.96	376.9	3/31/2024		138.96
6130	Viola Municipal Water And Electric Utility	Mg-1	Vernon	D	29.49	54.99	80.49	93.24	109.18	325.49	1/31/2025		138.67
5795	Suamico Water Utility	Mg-1	Brown	C	30	55.08	80.16	92.7	108.38	343.5	6/14/2023		138.38
1750	Edgar Municipal Water Utility	Mg-1	Marathon	D	26.05	53.65	81.25	95.05	112.3	350.7	1/1/2024	1	138.35
4150	Niagara Municipal Water Utility	Mg-1	Marinette	D	27.9	54.3	80.7	93.9	110.4	357.9	9/2/2023		138.3
3610	Merrill Water Utility	Mg-1	Lincoln	C	28.4	54.4	80.4	93.4	109.65	353.4	3/1/2022		138.05
2430	Hammond Municipal Water Utility	Mg-1	Saint Croix	D	24.99	53.07	81.15	95.19	112.74	323.91	1/1/2025		137.73
1900	Fairwater Municipal Water Utility	Mg-1R	Fond du Lac	D	35.38	56.74	78.1	88.78	102.13	302.38	12/20/2025		137.51
3250	Lyndon Station Municipal Water Utility	Mg-1	Juneau	D	24.72	52.86	81	95.07	112.66	342.37	7/1/2024		137.38
1620	Dickeyville Water Utility	Mg-1	Grant	D	27.81	53.97	80.13	93.21	109.56	324.81	9/23/2025		137.37
3480	Mazomanie Water Utility	Mg-1	Dane	D	37.56	57.42	77.28	87.21	99.62	230.19	4/1/2025		137.18
3300	Manawa Municipal Water Utility	Mg-1	Waupaca	D	26.33	53.33	80.33	93.83	110.71	353.48	3/16/2020		137.04
2480	Hartland Municipal Water Utility	Mg-1	Waukesha	C	30.78	54.84	78.9	90.93	105.97	293.28	12/16/2025	1	136.75
1675	Downsville Sanitary District No 1	Mg-1	Dunn	D	30	54.54	79.08	91.35	106.69	300.5	3/31/2025		136.69
2860	Kieler Sanitary District #1	Mg-1	Grant	D	30	54.48	78.96	91.2	106.5	311.25	3/1/2025		136.5
3680	Village of Milltown Water Utility	Mg-1	Polk	D	25.83	52.95	80.07	93.63	110.58	329.33	10/1/2025		136.41
2330	Village of Grantsburg Municipal Water Utility	Mg-1	Burnett	D	27	53.28	79.56	92.7	109.13	326.34	9/22/2025		136.13
2610	Village of Hortonville Water and Sewer	Mg-1	Outagamie	C	29.25	53.85	78.45	90.75	106.13	300.75	3/21/2016		135.38
1520	Dallas Municipal Water Utility	Mg-1	Barron	D	24.9	52.2	79.5	93.15	110.21	332.4	6/30/2014		135.11
3410	Marshall Water And Sewer Utility	Mg-1	Dane	C	27.51	53.13	78.75	91.56	107.57	347.76	1/1/2026	1	135.08
120	Altoona Municipal Water And Sewer Utility	Mg-1R	Eau Claire	C	25.8	52.5	79.2	92.55	109.24	359.55	6/17/2024		135.04
900	Village of Caledonia Water Utility	Mg-1	Racine	AB	22.09	51.05	80.01	94.49	112.59	384.09	3/15/2021		134.68
5510	Slinger Utilities	Mg-1	Washington	C	26.1	52.2	78.3	91.35	107.66	332.91	11/1/2024	1	133.76
1060	Chaseburg Water and Sewer Utility	Mg-1	Vernon	D	27	52.5	78	90.75	106.69	325.8	10/4/2019		133.69
1720	Eastman Water Utility	Mg-1	Crawford	D	27	52.5	78	90.75	106.69	329.5	7/1/2012	1	133.69
2300	Grafton Water and Wastewater Utility	Mg-1R	Ozaukee	AB	29.7	53.16	76.62	88.35	103.01	322.95	9/20/2025		132.71
2880	Knapp Municipal Water And Sewer Utility	Mg-1	Dunn	D	17.51	48.71	79.91	95.51	115.01	407.51	12/26/2025		132.52
3360	Maribel Municipal Water and Sewer Utility	Mg-1	Manitowoc	D	30	53.16	76.32	87.9	102.38	319.5	12/15/2022		132.38
4760	Portage Water Utility	Mg-1	Columbia	C	23.61	50.85	78.09	91.71	108.74	364.11	9/1/2024		132.35
2540	Hilbert Municipal Water Utility	Mg-1	Calumet	D	33.72	54.48	75.24	85.62	98.6	263.12	12/31/2024		132.32
2160	City of Galesville Municipal Water and Sewer Utility	Mg-1	Trempealeau	D	20.05	49.51	78.97	93.7	112.11	354.1	1/1/2026		132.16
5700	Stitzer Sanitary District	Mg-1	Grant	D	30	52.74	75.48	86.85	101.06	309	10/1/2024		131.06
760	Brookfield Municipal Water Utility	Mg-1R	Waukesha	AB	20.7	47.7	75.86	91.1	110.15	413.45	12/1/2025		130.85
770	Brooklyn Water Utility	Mg-1	Green	D	29.76	52.56	75.36	86.76	101.01	303.56	7/26/2024		130.77
3450	City of Mauston Municipal Water Utility	Mg-1	Juneau	C	31.5	53.16	74.82	85.65	99.19	297.96	1/1/2019		130.69
4630	Phelps Sanitary Dist 1	Mg-1	Vilas	D	27.9	51.78	75.66	87.6	102.53	299.4	10/1/2010		130.43
6330	Wauzeka Municipal Water Utility	Mg-1	Crawford	D	27	51.42	75.84	88.05	103.31	283.75	4/1/2017		130.31
4650	Pigeon Falls Municipal Water Utility	Mg-1	Trempealeau	D	15.45	47.25	79.05	94.95	114.83	370.7	1/15/2026		130.28
1760	Edgerton Municipal Water Utility	Mg-1	Rock	C	27.16	51.4	75.64	87.76	102.91	315.66	12/1/2023	1	130.07
6310	Wausaukee Water and Sewer Utility	Mg-1	Marinette	D	34.74	54	73.26	82.89	94.93	275.49	1/1/2025		129.67
2060	City of Fort Atkinson Water Utility	Mg-1	Jefferson	AB	21.71	49.23	76.75	90.51	107.71	271.36	7/1/2024		129.42
4930	Random Lake Municipal Water Department	Mg-1	Sheboygan	D	31.23	52.53	73.83	84.48	97.79	297.48	1/1/2025		129.02
2350	Green Bay Water Utility	Mg-1	Brown	AB	27	51	75	87	102	327	8/1/2024		129
1470	Cuba City Electric and Water Utility	Mg-1	Lafayette	D	26.4	50.56	74.72	86.8	101.9	318.4	11/21/2024		128.3
4005	City of Muskego Water Public Utility	Mg-1	Waukesha	AB	28.96	51.4	73.84	85.06	99.09	288.31	1/1/2025		128.05

Utility ID	Utility Name	Rate Schedule	County	Utility Class	Minimum Quarterly Bill (0.625 inch meter)	6000 GAL	12000 GAL	15000 GAL	18750 GAL	75000 GAL	Effective Date	Footnote	J+F
6520	Whitewater Municipal Water Utility	Mg-1R	Walworth	C	29.4	47.28	71.16	83.1	98.03	321.9	4/28/2023		127.43
5630	Spooner Municipal Utilities	Mg-1	Washburn	C	36.78	54	71.22	79.83	90.59	252.03	1/1/2024	1	127.37
2830	Kewaskum Municipal Water Utility	Mg-1	Washington	C	33.36	52.74	72.12	81.81	93.92	266.11	12/1/2023	1	127.28
3390	Markesan Municipal Water Plant	Mg-1	Green Lake	D	27	50.4	73.8	85.5	100.13	303	6/21/2018		127.13
5071	Richland Center Water Utility	Mg-1	Richland	C	31.5	51.96	72.42	82.65	95.44	259.89	8/6/2020		126.94
4990	Reeseville Water Utility	Mg-1	Dodge	C	33.3	52.56	71.82	81.45	93.49	274.05	12/31/2018		126.79
4170	Nichols Municipal Water Utility	Mg-1R	Outagamie	D	27.81	50.37	72.93	84.21	98.31	309.81	12/30/2025		126.12
4960	Redgranite Water Utility	Mg-1	Waushara	D	39.93	54.45	68.97	76.23	85.31	213.78	1/1/2025		125.24
1490	Cumberland Municipal Utility	Mg-1	Barron	C	33	51.9	70.8	80.25	92.06	259.8	5/31/2023		125.06
3060	Laona Sanitary District No 1	Mg-1	Forest	D	28.5	50.28	72.06	82.95	96.56	257.55	4/1/2025		125.06
1680	Dresser Municipal Water Utility	Mg-1	Polk	D	39	54	69	76.5	85.88	208.5	12/21/2023		124.88
2210	Germantown Water Utility	Mg-1	Washington	AB	21	47.1	73.2	86.25	102.56	347.25	12/15/2024		123.56
4900	Racine Water Works Commission	Mg-1	Racine	AB	22.3	47.18	72.06	84.5	100.05	333.3	10/26/2020		122.35
5610	Sparta Municipal Water Department	Mg-1	Monroe	AB	28.65	49.45	70.25	80.65	93.65	283.75	2/15/2024		122.3
2770	Johnson Creek Water Utility	Mg-1	Jefferson	C	37.23	52.47	67.71	75.33	84.86	227.73	6/28/2024		122.09
6545	Village of Wilson Municipal Water Utility	Mg-1	Saint Croix	D	18	45.54	73.08	86.85	104.06	362.25	1/2/2013		122.06
705	Bridgeport Sanitary Dist	Mg-1	Crawford	D	21	46.6	72.2	85	101	341	12/1/2023		122
3520	Medford Water works	Mg-1	Taylor	C	26.88	48.54	70.2	81.03	94.57	285.03	1/1/2022	1	121.45
5365	City of Shawano Water and Sewer Utility	Mg-1	Shawano	AB	28.2	49	69.8	80.2	93.2	262.7	12/31/2023		121.4
2590	Holmen Municipal Water Utility	Mg-1R	La Crosse	C	30	49.62	69.24	79.05	91.31	275.25	1/1/2025		121.31
740	Brodhead Water And Light Commission	Mg-1	Rock	C	24.75	47.71	70.67	82.15	96.5	303.71	9/1/2025		121.25
3030	Lancaster Municipal Water Utility	Mg-1R	Grant	C	26.34	48.24	70.14	81.09	94.78	300.09	1/22/2024	1	121.12
5930	Tomahawk Municipal Water and Sewer Utility	Mg-1	Lincoln	C	21.63	46.51	71.39	83.83	99.38	318.83	10/3/2025		121.01
2850	City of Kiel Utilities	Mg-1	Manitowoc	C	27	48.36	69.72	80.4	93.75	285.5	2/4/2022		120.75
4420	Ontario Municipal Water Utility	Mg-1	Vernon	D	18.64	45.34	72.04	85.39	102.08	302.44	12/21/2023		120.72
5260	Sauk City Municipal Water and Light Utility	Mg-1	Sauk	C	30.9	49.62	68.34	77.7	89.4	260.22	9/28/2025		120.3
6360	West Allis Municipal Water Utility	Mg-1	Milwaukee	AB	22.8	46.48	70.16	82	96.8	318.8	2/1/2025		119.6
6210	Village of Waterford Water and Sewer Utility	Mg-1	Racine	C	24.69	47.13	69.57	80.79	94.82	289.09	1/1/2026		119.51
1150	Clayton Municipal Water Utility	Mg-1	Polk	D	28.11	48.21	68.31	78.36	90.92	236.86	1/1/2025		119.03
4310	Oak Creek Water and Sewer Utility	Mg-1	Milwaukee	AB	27.58	47.92	68.26	78.43	91.14	281.83	11/15/2017		118.72
4840	Village of Prentice Water and Sewer Utility	Mg-1	Price	D	21.55	45.73	69.91	82	97.11	296.15	4/1/2020		118.66
6480	Village of Whitefish Bay Water Utility	Mg-1	Milwaukee	AB	27.81	47.97	68.13	78.21	90.81	279.81	12/1/2025		118.62
1505	Curtiss Municipal Water and Sewer Utility	Mg-1	Clark	D	26.4	47.4	68.4	78.9	92.03	288.9	8/10/2016		118.43
5500	Sister Bay Water And Sewer Utility	Mg-1	Door	C	31.5	49.2	66.9	75.75	86.81	243.5	9/15/2018		118.31
3780	Mondovi Municipal Water And Sewer Utility	Mg-1	Buffalo	C	22.58	45.98	69.38	81.08	95.71	304.73	1/1/2026		118.29
6185	Warrens Municipal Water and Sewer Utilities	Mg-1	Monroe	D	30.27	48.75	67.23	76.47	88.02	261.27	12/29/2023		118.29
1100	Chilton Municipal Water Utility	Mg-1	Calumet	C	18.88	44.62	70.36	83.23	99.32	322.63	12/15/2023	1	118.2
4620	Village of Pewaukee Water Utility	Mg-1	Waukesha	C	24	46.38	68.76	79.95	93.94	300.5	3/1/2022		117.94
1545	Darboy Joint Sanitary District No 1	Mg-1	Outagamie	AB	18	44.16	70.32	83.4	99.75	345	9/24/2021		117.75
6380	City of West Bend Water Utility	Mg-1	Washington	AB	21	44.92	68.84	80.8	95.75	320	10/1/2025		116.75
2500	City of Hayward Waterworks And Sewer	Mg-1	Sawyer	C	24	45.9	67.8	78.75	92.44	276.15	2/17/2012	1	116.44
3140	Little Chute Municipal Water Department	Mg-1	Outagamie	AB	19.11	43.95	68.79	81.21	96.74	312.96	9/29/2015	1	115.85
1560	Dartington Municipal Water And Sewer Utility	Mg-1	Lafayette	C	22.69	45.19	67.69	78.94	93	257.44	12/1/2023	1	115.69
5970	Turtle Lake Municipal Water and Sewer Utility	Mg-1	Polk	D	25.92	46.32	66.72	76.92	89.67	279.67	10/1/2023	1	115.59
2110	Frederic Water Commission	Mg-1R	Polk	D	25.49	46.13	66.77	77.09	89.99	283.49	4/1/2020		115.48
6170	Waldo Water And Sewer Utility	Mg-1	Sheboygan	D	30.78	48	65.22	73.83	84.59	246.03	8/21/2023		115.37
320	Baldwin Municipal Water Utility	Mg-1R	Saint Croix	C	22.21	44.89	67.57	78.91	93.09	305.71	10/1/2025		115.3
360	City of Baraboo Water Utility	Mg-1	Sauk	AB	25.03	45.79	66.55	76.93	89.91	278.16	1/1/2026		114.94
5640	Spring Green Municipal Water Utility	Mg-1	Sauk	D	27	46.44	65.88	75.6	87.75	222.75	1/1/2021		114.75
6420	Weston Water Utility	Mg-1R	Marathon	AB	27.09	43.77	62.11	72.94	86.48	325.54	10/15/2023		113.57
3700	City of Milton Municipal Water Utility	Mg-1	Rock	C	30.9	47.22	63.54	71.7	81.9	233.22	10/30/2025	1	112.8
2270	Glenwood City Municipal Water Utility	Mg-1	Saint Croix	D	25.92	45.36	64.8	74.52	86.67	239.22	12/20/2023		112.59
1820	Ellsworth Municipal Water And Sewer Utility	Mg-1	Pierce	C	25.5	45.18	64.86	74.7	87	268.1	11/20/2024		112.5
4140	New Richmond Municipal Water Utility	Mg-1R	Saint Croix	AB	36	48.9	61.8	68.25	76.31	193.89	2/24/2021		112.31
1885	Exeland Municipal Water Utility	Mg-1	Sawyer	D	27.81	45.93	64.05	73.11	84.44	254.31	1/1/2026		112.25
5100	Rio Municipal Water Utility	Mg-1	Columbia	D	22.28	43.94	65.6	76.43	89.97	277.03	1/1/2026	1	112.25
220	Arena Municipal Water Utility	Mg-1	Iowa	D	31.23	46.83	62.43	70.23	79.98	207.78	11/27/2024		111.21
780	Brown Deer Water Public Utility	Mg-1	Ozaukee	C	24.68	44.18	63.68	73.43	85.62	265.43	12/1/2024		110.3
1240	Cochrane Municipal Water Utility	Mg-1	Buffalo	D	16.15	41.11	66.07	78.55	94.15	255.4	10/1/2025		110.3
2720	Village of Jackson Water Utility	Mg-1	Washington	C	26.58	44.82	63.06	72.18	83.58	227.58	1/1/2025		110.16
2220	Gillett Water And Sewer Commission	Mg-1	Oconto	D	21.87	43.11	64.35	74.97	88.25	287.37	9/17/2024	1	110.12
2375	Greenville Utilities	Mg-1	Outagamie	C	26.55	44.73	62.91	72	83.36	253.8	1/1/2025		109.91
4690	Village of Plainfield Water Utility	Mg-1	Waushara	D	20.4	42.42	64.44	75.45	89.21	216.45	4/15/2025	1	109.61
1740	Eau Claire Municipal Water Utility	Mg-1R	Eau Claire	AB	23.61	43.53	63.45	73.41	85.86	272.61	2/1/2025		109.47
6740	Wittenberg Municipal Water and Sewer Utility	Mg-1R	Shawano	D	24.72	43.62	62.52	71.97	83.78	260.97	1/1/2026		108.5
3380	Marion Municipal Water And Sewer Utility	Mg-1	Waupaca	D	18.91	41.47	64.03	75.31	89.41	257.71	12/15/2025		108.32
1830	Elmwood Municipal Water Utility	Mg-1	Pierce	D	19.95	41.79	63.63	74.55	88.2	272.41	2/1/2018		108.15

Utility ID	Utility Name	Rate Schedule	County	Utility Class	Minimum Quarterly Bill (0.625 inch meter)	6000 GAL	12000 GAL	15000 GAL	18750 GAL	75000 GAL	Effective Date	Footnote	J+F
6450	City of Weyauwega Water and Sewer Utility	Mg-1	Waupaca	D	34.5	46.98	59.46	65.7	73.5	190.5	3/31/2022		108
2870	Kimberly Municipal Water Utility	Mg-1	Outagamie	C	18	40.92	63.84	75.3	89.63	300.72	4/1/2019		107.63
60	Allenton Sanitary District No 1	Mg-1	Washington	D	18.81	41.19	63.57	74.76	88.75	285.06	12/8/2022		107.56
6100	Verona Water Utility	Mg-1R	Dane	AB	21	41.88	62.76	73.2	86.25	282	9/16/2019		107.25
2130	Fredonia Municipal Water Utility	Mg-1R	Ozaukee	D	20.97	41.79	62.61	73.02	86.03	281.22	1/1/2026		107
5050	Rice Lake Municipal Water and Electric Utility	Mg-1	Barron	C	30	45	60	67.5	76.88	215.61	5/1/2022		106.88
4410	Onalaska Municipal Water Utility	Mg-1R	La Crosse	AB	20.24	41.2	62.16	72.64	85.74	282.24	1/1/2025		105.98
3720	Milwaukee Water Works	Mg-1R	Milwaukee	AB	21.22	41.46	61.7	71.82	84.47	274.22	8/1/2025		105.69
3220	Luck Municipal Water Utility	Mg-1	Polk	D	25.08	42.66	60.24	69.03	80.02	218.98	6/1/2022	1	105.1
520	Black Creek Municipal Water and Sewer Utility	Mg-1	Outagamie	D	24.48	42.42	60.36	69.33	80.54	235.05	1/1/2025		105.02
980	Cassville Water and Sewer Utility	Mg-1	Grant	D	20.42	40.94	61.46	71.72	84.55	256.42	9/20/2025		104.97
2975	Village of Lake Delton Water Utility	Mg-1	Sauk	C	33.9	45.6	57.3	63.15	70.46	180.15	7/1/1998		104.36
6110	Vesper Municipal Water And Sewer Utility	Mg-1R	Wood	D	25.05	42.27	59.49	68.1	78.86	240.3	11/17/2025		103.91
3580	Village of Menomonee Falls Water Utility	Mg-1	Waukesha	AB	11.52	37.38	63.24	76.17	92.33	309.97	1/1/2017		103.85
4790	Potosi Municipal Water Utility	Mg-1	Grant	D	19.18	40.12	61.06	71.53	84.62	260.23	6/30/2025		103.8
3950	Mount Horeb Water And Sewer Utility	Mg-1	Dane	C	22.5	41.1	59.7	69	80.63	255	6/1/2016	1	103.13
650	Boscobel Municipal Utilities	Mg-1	Grant	C	25.68	42.12	58.56	66.78	77.06	231.18	8/29/2023	1	102.74
6445	Westport Water Utility District	Mg-1	Dane	D	24	41.58	59.16	67.95	78.64	238.95	8/24/2013	1	102.64
4060	Nelson Water And Sewer Department	Mg-1	Buffalo	D	25.05	41.85	58.65	67.05	77.55	235.05	12/16/2024		102.6
5045	Rib Mountain Water Utility	Mg-1	Marathon	C	30	43.62	57.24	64.05	72.56	200.25	12/1/2025		102.56
4440	Oregon Municipal Water And Sewer Utility	Mg-1	Dane	AB	21	40.08	59.16	68.7	80.63	236.1	10/31/2023		101.63
4230	North Fond Du Lac Water Utility	Mg-1	Fond du Lac	C	23.18	40.82	58.46	67.28	78.31	243.68	1/1/2016	1	101.49
1580	DeForest Municipal Water Utility	Mg-1	Dane	C	21.63	39.87	58.11	67.23	78.63	228.93	1/1/2021		100.26
3820	Monroe Municipal Water Utility	Mg-1	Green	AB	21.06	39.54	58.02	67.26	78.81	239.26	12/5/2023		99.87
4560	Patch Grove Municipal Water Utility	Mg-1	Grant	D	17.82	38.34	58.86	69.12	81.95	274.32	12/27/2023		99.77
3240	Luxemburg Municipal Water Utility	Mg-1	Kewaunee	C	20.94	39.3	57.66	66.84	78.32	225.69	9/15/2025		99.26
2901	Kronenwetter Water Utility	Mg-1	Marathon	C	16.2	37.74	59.28	70.05	82.91	275.85	12/20/1999	1	99.11
1790	Elkhart Lake Water Department	Mg-1	Sheboygan	D	21.06	39.22	57.38	66.46	77.81	226.36	4/1/2025		98.87
4737	Village of Plover Municipal Water Utility	Mg-1	Portage	AB	18	37.98	57.96	67.95	80.44	267.3	4/1/2022		98.44
6818	Wycocena Municipal Water and Sewer Utility	Mg-1	Columbia	D	21.86	39.32	56.78	65.51	76.42	240.11	9/20/2024		98.28
1120	Chippewa Falls Department of Public Utilities	Mg-1	Chippewa	AB	22.5	39.54	56.58	65.1	75.75	223.6	1/2/2025		98.25
1010	Cedar Grove Municipal Water Utility	Mg-1	Sheboygan	D	21.65	39.29	56.93	65.75	76.4	213.65	3/20/2024		98.05
2980	Lake Geneva Utility Commission	Mg-1	Walworth	AB	19.1	38.22	57.34	66.9	78.85	258.1	12/9/2019		97.95
1210	Clyman Utility Commission	Mg-1	Dodge	D	32.7	42.84	52.98	58.05	64.39	129.36	9/8/2025		97.09
6180	Walworth Municipal Water And Sewer Utility	Mg-1	Walworth	C	19.47	38.01	56.55	65.82	77.41	251.22	1/15/2026		96.88
6390	Brookfield Tn Of Sanitary Dist No 4	Mg-1	Waukesha	C	30.3	41.88	53.46	59.25	66.49	175.05	6/20/2025		96.79
2740	Janesville Water Utility	Mg-1R	Rock	AB	16.34	34.58	53.53	65.49	80.44	356.29	9/1/2024		96.78
4850	City of Prescott Municipal Water Utility	Mg-1	Pierce	C	24.75	39.87	54.99	62.55	72	207.45	4/1/2025		96.75
2190	Genoa Municipal Water And Sewer Utility	Mg-1	Vernon	D	24	39.48	54.96	62.7	72.38	217.5	6/25/2019		96.38
3770	Mishicot Water Utility and Sewer Department	Mg-1	Manitowoc	D	22.68	39	55.32	63.48	73.68	226.68	9/19/2023		96.36
1645	Dodge Sanitary District #1	Mg-1	Trempealeau	D	16.35	36.69	57.03	67.2	79.91	270.6	1/1/2026		96.26
1480	City of Cudahy Water Utility	Mg-1R	Milwaukee	D	19.65	37.65	55.65	64.65	75.9	244.65	2/1/2022		95.55
4520	Village of Palmyra Water and Sewer Utility	Mg-1	Jefferson	D	18.54	37.2	55.86	65.19	76.85	232.44	12/17/2013		95.39
5690	Stevens Point Municipal Water Utility	Mg-1R	Portage	AB	29.66	41.18	52.7	58.46	65.66	173.66	12/1/2021		95.32
5370	Sheboygan Water Utility	Mg-1	Sheboygan	AB	15.78	36.02	56.26	66.38	79.03	268.78	4/1/2025		94.81
3590	City of Menomonie Water Department	Mg-1R	Dunn	AB	15.54	35.62	55.7	65.74	78.29	266.54	9/1/2023		93.83
6060	Valders Public Utility	Mg-1	Manitowoc	D	25.73	39.23	52.73	59.48	67.92	177.38	12/30/2024		93.65
3190	Lone Rock Utilities	Mg-1	Richland	D	18	36.18	54.36	63.45	74.81	225.75	9/30/2021		92.81
4020	Village of Necedah Municipal Water Utility	Mg-1	Juneau	D	24.41	38.45	52.49	59.51	68.29	174.61	10/1/2025		92.7
6400	City of Westby Municipal Electric and Water Utility	Mg-1	Vernon	C	16.17	35.13	54.09	63.57	75.42	207.67	7/31/2025		91.59
4585	Village of Bloomfield Utility Department	Mg-1	Walworth	C	18.54	35.82	53.1	61.74	72.54	224.04	12/16/2025		91.08
6160	Wabeno Sanitary District No 1	Mg-1	Forest	D	28.15	39.19	50.23	55.75	62.65	141.4	12/26/2024	1	90.8
5120	Village of Roberts Water Utility	Mg-1	Saint Croix	D	15.45	34.59	53.73	63.3	75.26	215.1	6/10/2018		90.71
2250	Glenbeulah Municipal Water Utility	Mg-1	Sheboygan	D	21.48	36.66	51.84	59.43	68.92	186.23	12/31/2023		90.4
6260	Wauwaukee Water And Light Commission	Mg-1	Dane	AB	20.25	36.15	52.05	60	69.94	208.2	12/1/2015	1	90.19
2820	Kenosha Water Utility	Mg-1	Kenosha	AB	15.86	34.5	53.14	62.46	74.11	242.98	7/3/2025		89.97
5110	River Falls Municipal Utility	Mg-1R	Pierce	AB	26.7	36.96	47.22	54.33	63.22	278.64	2/3/2025		89.92
2670	Iola Municipal Water Utility	Mg-1	Waupaca	D	18	35.16	52.32	60.9	71.63	205.05	9/30/2022		89.63
6280	Waupaca Water Utility	Mg-1	Waupaca	C	18.33	35.25	52.17	60.63	71.21	204.84	2/1/2025	1	89.54
4820	Prairie Du Chien Municipal Water Utility	Mg-1	Crawford	C	18.54	35.26	51.98	60.34	70.79	227.54	3/5/2022	1	89.33
405	Beaver Brook Sanitary District No 1	Mg-1	Washburn	D	16.68	34.32	51.96	60.78	71.81	231.78	8/1/2021	3	88.49
6620	Wisconsin Dells Municipal Water Utility	Mg-1	Sauk	C	25.14	37.26	49.38	55.44	63.02	176.64	4/14/2025	1	88.16
1990	Fitchburg Water Utility	Mg-1R	Dane	AB	18	32.64	48.76	57.19	69.38	288.94	3/16/2024		87.38
440	Belmont Municipal Water And Electric Utility	Mg-1	Lafayette	D	19.14	34.68	50.22	57.99	67.7	190.95	10/15/2025		86.84
3640	Middleton Municipal Water Utility	Mg-1R	Dane	AB	17.74	33.88	50.02	58.09	68.18	219.49	12/15/2025		85.92

Utility ID	Utility Name	Rate Schedule	County	Utility Class	Minimum Quarterly Bill (0.625 inch meter)	6000 GAL	12000 GAL	15000 GAL	18750 GAL	75000 GAL	Effective Date	Footnote	J+F
6510	Whitelaw Municipal Water And Sewer Utility	Mg-1	Manitowoc	D	26.85	37.11	47.37	52.5	58.91	132.15	9/30/2024		85.76
5300	Seneca Tn Of Sanitary District 1	Mg-1	Crawford	D	17.77	33.67	49.57	57.52	67.46	203.77	1/1/2026		85.23
500	Biramwood Municipal Water Utility	Mg-1	Shawano	D	15	32.1	49.2	57.75	68.44	209.5	8/29/2014		83.44
2920	La Crosse Water Utility	Mg-1R	La Crosse	AB	23.31	32.19	44.91	51.27	59.22	178.47	10/2/2019		82.53
1930	Fall River Municipal Water Utility	Mg-1	Columbia	D	21.36	33.84	46.32	52.56	60.36	167.46	1/1/2025	1	81.72
2485	Village of Haugen Water Utility	Mg-1	Barron	D	21.6	33.9	46.2	52.35	60.04	154.2	1/2/2025		81.64
3320	Manitowoc Public Utilities	Mg-1	Manitowoc	AB	16.35	31.95	47.55	55.35	65.1	206.75	12/1/2023		81.45
5310	Sextonville Waterworks San Dist	Mg-1	Richland	D	27	35.46	43.92	48.15	53.44	132.75	1/2/2025		80.44
455	Beloit Water Utility	Mg-1R	Rock	AB	21	33.16	45.32	51.4	59	173	5/1/2017	1	80
2460	Harmony Grove Sanitary District #1	Mg-1	Columbia	D	25.5	34.68	43.86	48.45	54.19	140.25	12/31/2024		79.69
2985	Lakeland Sanitary District #1	Mg-1	Vilas	C	16.34	31.34	46.34	53.84	63.22	177.24	12/1/2024		79.56
4970	Reedsburg Utility Commission	Mg-1	Sauk	C	13.62	30.18	46.74	55.02	65.37	190.72	7/25/2025		78.99
3910	Village of Mount Calvary Municipal Water and Sewer	Mg-1	Fond du Lac	D	18.24	31.74	45.24	51.99	60.43	186.99	9/15/2025		78.67
2630	Hudson Public Utilities	Mg-1R	Saint Croix	AB	16.2	30.92	45.64	53	62.2	200.2	10/1/2021		78.4
6430	West Salem Municipal Joint Water and Sewer Utility	Mg-1	La Crosse	C	12.23	29.33	46.43	54.98	65.67	225.98	7/22/2025	1	77.9
6570	Windsor Sanitary District Number One	Mg-1	Dane	C	25.38	34.02	42.66	46.98	52.38	127.53	5/31/2015		77.76
680	Boyceville Municipal Water Utility	Mg-1	Dunn	D	14.75	29.99	45.23	52.85	62.38	182.75	1/1/2025		77.13
140	Amery Municipal Joint Water and Sewer Utility	Mg-1	Polk	C	18.13	31.03	43.93	50.38	58.44	148.64	7/1/2025		76.57
380	Barron Light And Water Utility	Mg-1	Barron	C	20.22	29.82	39.42	44.22	50.22	135.72	2/21/2025		70.44
730	Town of Brockway Sanitary District 1	Mg-1	Jackson	D	18.68	28.76	38.84	43.88	50.18	139.28	9/1/2009		68.86
4770	Port Edwards Water Utility	Mg-1	Wood	D	16.44	27.72	39	44.64	51.69	157.44	9/18/2023	1	68.13
4000	Muscoda Light And Water Utility	Mg-1	Iowa	D	16.8	25.56	34.32	38.7	44.18	126.3	12/25/2012		60.98
5360	Shawano Lake Sanitary District #1	Mg-1	Shawano	C	12.51	23.85	33.99	39.06	45.4	131.01	7/1/2021		57.91
1160	Clear Lake Municipal Water Utility	Mg-1	Polk	D	12.6	22.32	32.04	36.9	42.98	117.45	3/18/2014		55.58



Engineering
Eric Lindman, Public Works Director

DATE: February 3, 2026
TO: Wausau Water Works Commission
SUBJECT: Update on the solar array project and possible schedule

PURPOSE

Discuss the status of the solar array project and possible schedule moving forward

BACKGROUND

The funding for the solar array project was approved by the City Council in the 2026 budget. The total funding approved is about \$2.8 million of possible borrowing and General Obligation debt. City staff has also applied for a USEPA Grant for the project in the amount of up to \$1.18 million. Results of the grant application results will not be announced until May/June 2026.

The initial strategy was to sole source the engineering/design/bid package preparation in order to meet the deadline of beginning construction prior to July 4, 2026. Doing so would have potentially reduced the amount of regulations/restrictions on the bidding and also allowed the City more time to construct the project and place the project online. The Finance Committee denied the sole source request. Staff prepared a complete RFP for professional engineering services and is soliciting proposals for the work. The proposals will be opened late February and with a contract in place in mid-March. Based on this timeline, we anticipate bidding for construction in June 2026. This will likely be construction starting in August 2026 with completion in 2027. Exact completion is unknown as we do not know the timeline for material ordering and delivery. Missing the July 4, 2026 construction date means we must be fully complete before the end of 2027 to be eligible for any possible tax credits.

Once we have an engineering firm under contract a schedule for project completion will be prepared and the Commission updated, anticipate the April meeting.

RECOMMENDATION

NA



Engineering
Eric Lindman, Public Works Director

DATE: February 3, 2026
TO: Wausau Water Works Commission
SUBJECT: Discussion on the annual Payment in Lieu of Tax (PILOT) paid to the city by Wausau Water Works

PURPOSE

Discuss annual PILOT payment from Wausau Water Works to City

BACKGROUND

Wausau Water Works has historically provided a PILOT payment annually to the City of Wausau. The current PILOT payment is \$1,590,000 from Drinking Water and approximately \$500,000 from wastewater. The PILOT payment for the Drinking Water Division is initially determined by the PSC through their rate review and based on the assets owned by the water utility. Based on this PSC determination, the City council may then determine whether to have that amount paid or change the amount to be paid by passing a resolution of the Common Council. Currently, the PSC has determined a fee of about \$2,000,000 to be paid by the Drinking Water Utility. The city council has frozen the annual payment for 2025 and 2026 at \$1,590,000.

RECOMMENDATION

Discussion and Commission feedback